



## **Patriot Bale Transporter**

### **Owner's Manual**



**Manufactured by  
Minden Machine Shop Inc.  
1302 K Road  
Minden NE 68959  
1-308-832-0220**

# Table of Contents

Introduction	3
Safety and Operation Rules	4
Safety Decals	8
Machine Measurements	11
Bolt Torque Table	14
Setup and Placement	15
Wheel Attachment and Torque	17
Parts Diagrams	21
Proposition 65	24
Warranty	26

## INTRODUCTION

Thank you for purchasing a Patriot Equipment product! We hope you will get many years of productive use from it. The product has been designed to perform a certain function. All product users must read and understand this manual prior to equipment operation. This manual is considered part of your machine and should remain with the machine at all times. Do not allow anyone to operate or maintain this equipment if they have not fully read and comprehended this manual. Failure to follow the recommended procedures may result in personal injury or death or equipment damage.

Information in this manual is designed to help owners and operators to obtain the best results and safe operation from their investment. The life of any machine depends largely on the care it is given and we suggest that the manual should be read and understood and referred to frequently. If for any reason you do not understand the instructions and safety requirements, please contact your authorized dealer. The intent of this manual is to provide guidelines to cover general use and to assist in avoiding accidents and injuries.

There may be times when circumstances occur that are not covered in the manual. At those times it is best to use common sense and contact your authorized dealer or our factory.

The requirements of safety cannot be emphasized enough in this publication. We urge you to make safety your top priority when using and maintaining the equipment. We strongly advise that anyone allowed to operate this equipment be thoroughly trained and tested, to prove they understand the fundamentals of safe operation.

Some photographs, diagrams or illustrations in this manual may show doors, guards and shields opened or removed to aid in clarity and understanding of a particular procedure. All guards, shields and safety devices must be in their proper position prior to operation.

# SAFETY AND OPERATION RULES

## General Safety Statements

Safety precautions are essential when the use of any mechanical equipment is involved. These precautions are necessary when using, storing, and servicing mechanical equipment. Using this equipment with the respect and caution demanded will considerably lessen the possibilities of personal injury. If safety precautions are overlooked or ignored, personal injury or property damage may occur.

The machine was designed for a specific application. It should not be modified and/or used for any application other than which it was designed. If there are any questions regarding its application, please write or call. Do not use this unit until you have been advised. For more information contact:

Patriot Equipment  
1302 K Rd  
Minden, NE 68959  
308-832-0220

Read this entire manual carefully. Know your equipment. Consider the application, limitations, and the potential hazards specific to your unit. Operator and bystander safety is of prime concern to us. This manual was written with the safety of the operator and others who come in contact with the equipment. This manual was written to help you understand the safe operating procedures of the product. We want you as our partner in safety. A copy of this manual should be available to all persons who may operate this machine.

It is your responsibility as an owner, operator, or supervisor to know what specific requirements, precautions, and work hazards exist and to make these known to all other personnel working with the equipment or in the area, so that they too may take any necessary safety precautions that may be required. Avoid any alterations of the equipment. Such alterations may create a dangerous situation where serious injury or death may occur and will void warranty.

Why is SAFETY important? Three reasons:

1. Accidents disable and kill
2. Accidents cost money
3. Accidents can be avoided

Note the use of the signal words **DANGER**, **WARNING**, and **CAUTION** with safety messages. The appropriate signal word for each message has been selected using the following guidelines:

**DANGER:** An immediate and specific hazard which will result in severe personal injury or death if proper precautions are not taken.

**WARNING:** A specific hazard or unsafe practice which could result in severe personal injury or death if proper precautions are not taken.

**CAUTION:** Unsafe practices which could result in personal injury if proper precautions are not taken or a reminder of good safety practices.

## Safety Alert Symbol



**BE ALERT! YOUR SAFETY IS INVOLVED!**

The symbol shown above is used to call your attention to instructions concerning your personal safety. Watch for this symbol – It points out important safety precautions. The symbol means: ATTENTION! BECOME ALERT! YOUR PERSONAL SAFETY IS INVOLVED! Read the message that follows and be alert to the possibility of personal injury or death.

Read this manual before operating or working around the equipment! This manual must be delivered with the equipment to its owner and operator. Failure to read this manual and its safety instructions is a misuse of equipment.

## Safety Equipment

Please, remember safety equipment provides important protection for persons around a machine that is in operation. Be sure ALL safety shields and protective devices are installed and properly maintained. If you find any shields or guards damaged or missing, contact Patriot Equipment for the correct items.

## Safety Procedures



1. Use only the correct equipment with the proper capacity when installing or removing the machine.
2. Use correct lifting equipment when filling the Bale Transporter. Equipment with too little capacity may tip towards the front where the lifted weight is.
3. Do not operate unit without safety shields or guards in place.
4. IMPORTANT: Use caution when transporting. Be alert of the transport unit's overall width when approaching obstacles, such as post sign and poles, along the road. Check the transport width of the unit to ensure clearance before entering.
5. Comply with all safety warnings and cautions in this manual as well as the operator's manuals of any tow vehicles that may be used.
6. Do not allow any riders on the machine.
7. Use the correct tow vehicle when using the Bale Transporter. The Bale Transporter is heavy and doesn't come with brakes, so the tow vehicle needs to be large enough to handle the Bale Transporter when fully loaded.
8. In case of any defect or awareness of potential danger, please contact Patriot Equipment at 1-800-264-6587 immediately.

## Operator Qualifications



Operation of this machine shall be limited to competent and experienced persons. In addition anyone who will operate or work around the machine must use good common sense. In order to be qualified, they must also know and meet all other requirements, such as:

1. Some regulations specify that no one under the age of 18 may operate power machinery. It is your responsibility to know what these regulations are in your own area or situation.
2. Current Occupational Safety Health Administration regulations state in part: "At the time of initial assignment and at least annually thereafter, the employer shall instruct every employee or user in the safe operation and servicing of all equipment with which the employee or user is, or will be involved."
3. Unqualified persons are to stay out of the work area.
4. A person who has not read and understood all operating and safety instruction is not qualified to operate the machine.

## Safety Overview

YOU are responsible for SAFE operation and maintenance of the machine. YOU must ensure that you and anyone who is going to operate and maintain or work around the machine must be familiar with the operating, maintenance, and safety information contained in the manual.

Remember YOU are the key to safety. GOOD PRACTICES protect not only you but also the people around you. Make these practices a working part of your safety program. Be certain EVERYONE operating this machine is familiar with the procedures recommended and follows safety precautions. Remember, most accidents can be prevented. Do not risk injury or death by ignoring any information addressed.

Machine owners must give operating instructions to operators before allowing them to operate the machine. They must be reviewed at least annually thereafter per OSHA regulation 1928.57.

The most important safety device on the equipment is a SAFE OPERATOR. It is the operator's responsibility to read and understand ALL instructions in the manual and to follow them. All accidents can be avoided!

Any person who has not read and understood all operation and safety instructions is not qualified to operate the machine. An untrained operator exposes himself and bystanders to possible serious injury or death.

Do not modify the equipment in any way. Unauthorized modifications may impair the functions and/or safety and could affect the life of the equipment.

## Safety Affirmation

1. I have read and understand the operator's manual and all safety signs before operation, maintenance, adjusting, or unplugging the machine.
2. I will allow only trained persons to operate the machine. \*An untrained operator is not qualified to operate this equipment.
3. I have access to a fire extinguisher.
4. I have all guards in place and will not operate the machine without them.
5. I will not allow riders on the machine.
6. I understand the danger of moving parts (rotating parts, hydraulics, and pinch points) and will stop engine before servicing.
7. I recognize the danger of the machine coming in contact with power lines.
8. I have the safety lock up pins and know and understand where and when to use them.
9. I understand that any accidents that occur with the machine are my responsibilities.
10. I understand that Patriot Equipment will not be held responsible for any accidents that involve the machine.

## Sign Off Sheet

(This sheet should be signed annually as part of your safety program)

As a requirement of OSHA, it is necessary for the owner/employer to train the employee in the safe operation and safety procedures with this machine. We include this sign off sheet for your convenience and personal record keeping.

DATE	EMPLOYER SIGNATURE	EMPLOYEE SIGNATURE

## **Machine Inspection**

After delivery of your new machine and/or completion of assembly, and before each use, inspection of the machine is mandatory. This inspection should include, but not be limited to:

1. Check to see that all guards are in place, secured and functional.
2. That all fasteners are tight.

## **Lighting and Marking**

It is the responsibility of the customer to know the lighting and marking requirements of the local highway authorities and to install and maintain the equipment to provide compliance with the regulations. Add extra lights when transporting at night or during periods of limited visibility if necessary.

## **Serial Number**

To ensure efficient and prompt service, please furnish us with the model and serial number of the machine in all correspondence or other contact. The serial number is located on a visible location of the machine.

## **Safety Decals**

1. Keep safety decals clear and legible at all times.
2. Replace decals and signs that are missing or have become unreadable.
3. Safety signs are available from your Dealer or the Manufacturer.

## **How to install Safety Decals**

1. Be sure that the installation area is clean and dry.
2. Decide on the exact position before you remove the backing paper.
3. Align the decal over the specified area and carefully press the small portion with the exposed sticky backing in place.
4. Slowly peel back the remaining paper and carefully smooth the remaining portion of the decal in place.
5. Small air pockets can be pierced with a pin and smoothed out using a piece of decal backing paper.



## Bale Transporter Decal Placement

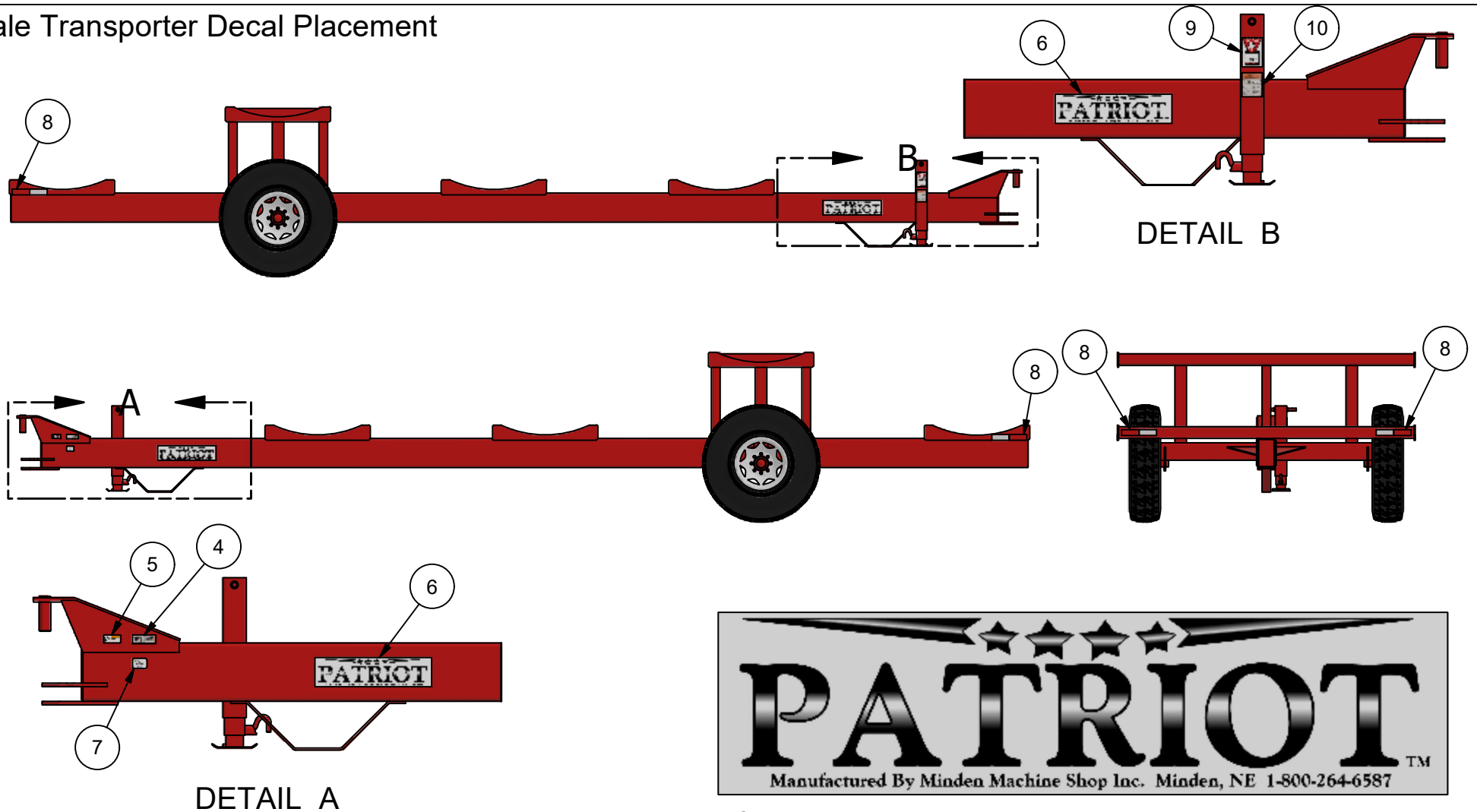

TS2001 White

### Parts List

ITEM	QTY	PART NUMBER	DESCRIPTION
4	1	TS2003	Serial Number Decal
5	1	TS2017	Read Manual Before Use
6	2	TS2001 White	5x20 Patriot Decal White
7	1	TS2018	P65 California
8	4	DOT RW Strip	Stock Decal
9	1	Bulldog Decal	With Jack
10	1	Jack Instructions	With Jack

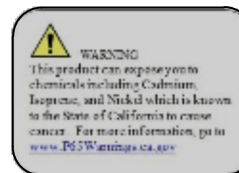

TS2018



TS2017



TS2003

**Patriot Equipment**  
1302 K Road Minden, NE  
308-832-0220

This drawing, and the information hereon, are the property of Minden Machine Shop Inc., and may be used only as authorized by us. Unpublished - All rights reserved under the copyright laws.

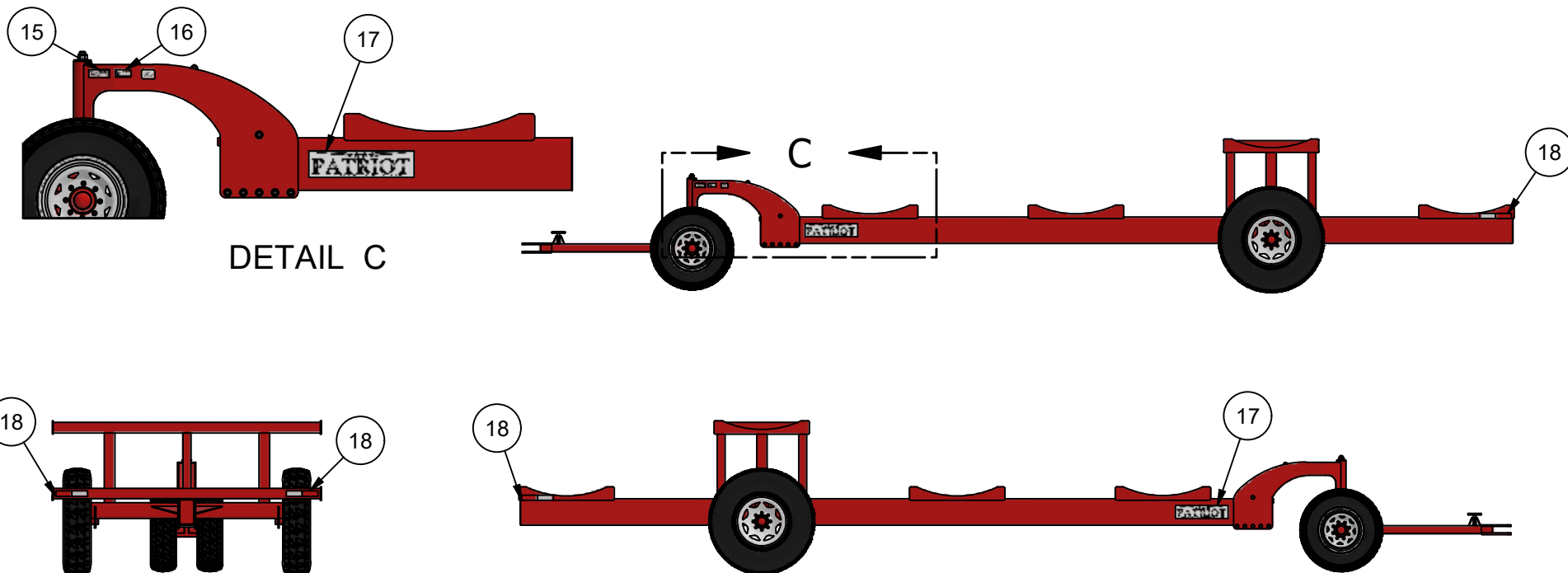

TS2001 White

#### Parts List

ITEM	QTY	PART NUMBER	DESCRIPTION
15	1	TS2003	Serial Number Decal
16	1	TS2017	Read Manual Before Use
17	2	TS2001 White	5x20 Patriot Decal White
18	4	DOT RW Strip	Stock Strip
19	1	TS2018	P65 California

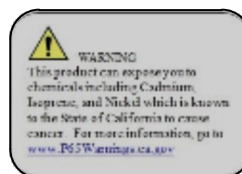

TS2018



TS2017



TS2003

**Patriot Equipment**  
1302 K Road Minden, NE  
308-832-0220

This drawing, and the information hereon, are the property of Minden Machine Shop Inc., and may be used only as authorized by us. Unpublished - All rights reserved under the copyright laws.

# Machine Measurements

Bale Transporter 6 Bale Specifications

2130 lbs.

Tires: VF44565R22.5

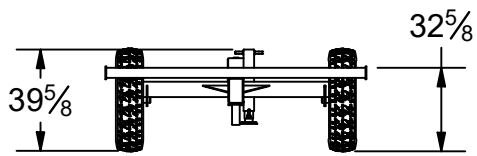
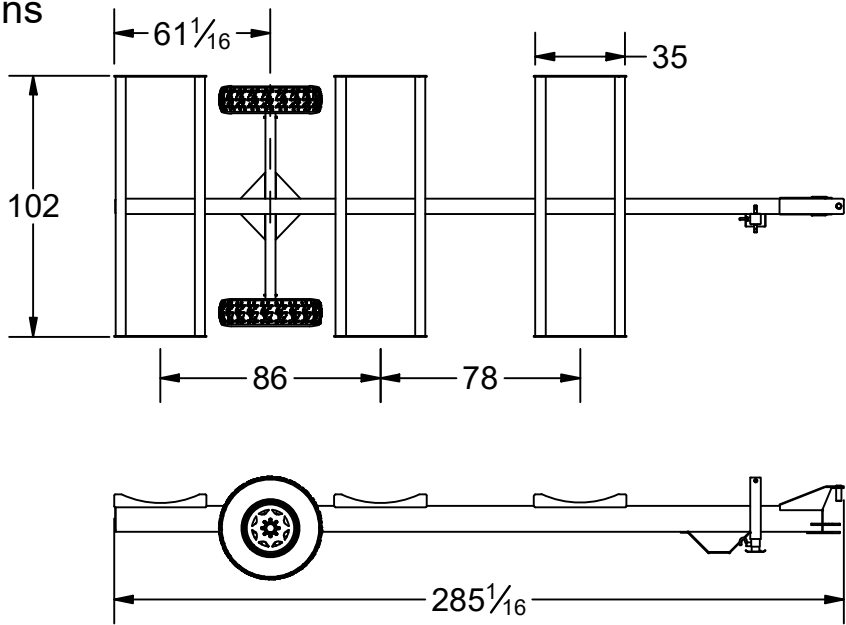

Bale Transporter Trolley 6 Bale Specifications

2230 lbs.

Tires: VF445 65R 22.5 Rear  
LT23585R16 Front

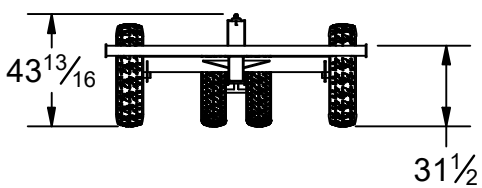
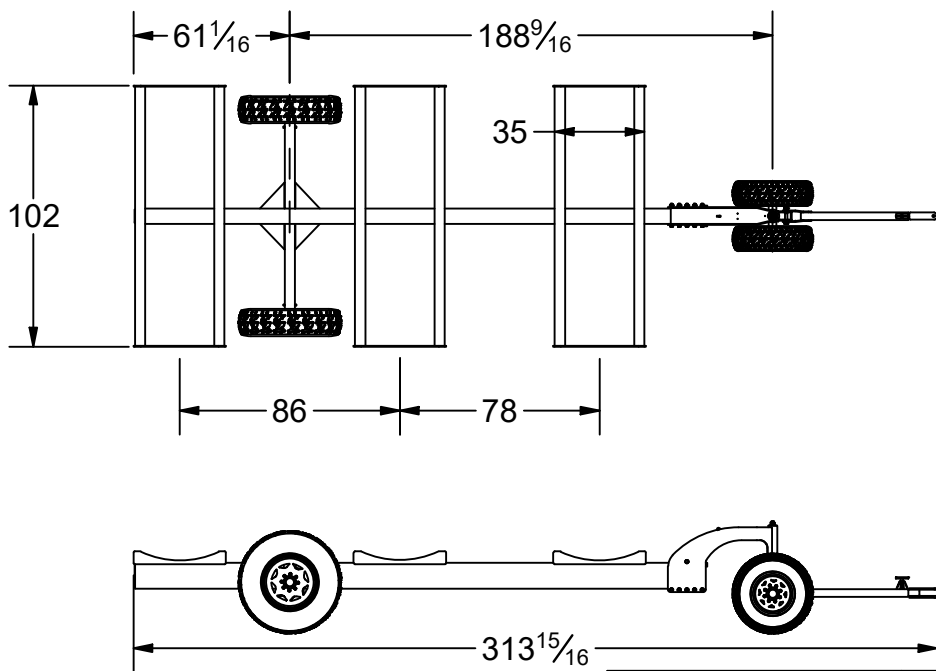

**Patriot Equipment**  
1302 K Road Minden, NE  
308-832-0220

This drawing, and the information hereon, are the property of Minden Machine Shop Inc., and may be used only as authorized by us. Unpublished - All rights reserved under the copyright laws.

Bale Transporter 8 Bale Specifications

2730 lbs.

Tires: VF44565R22.5

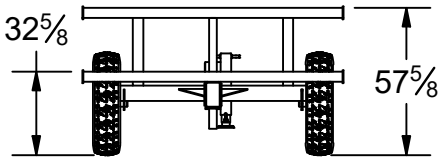
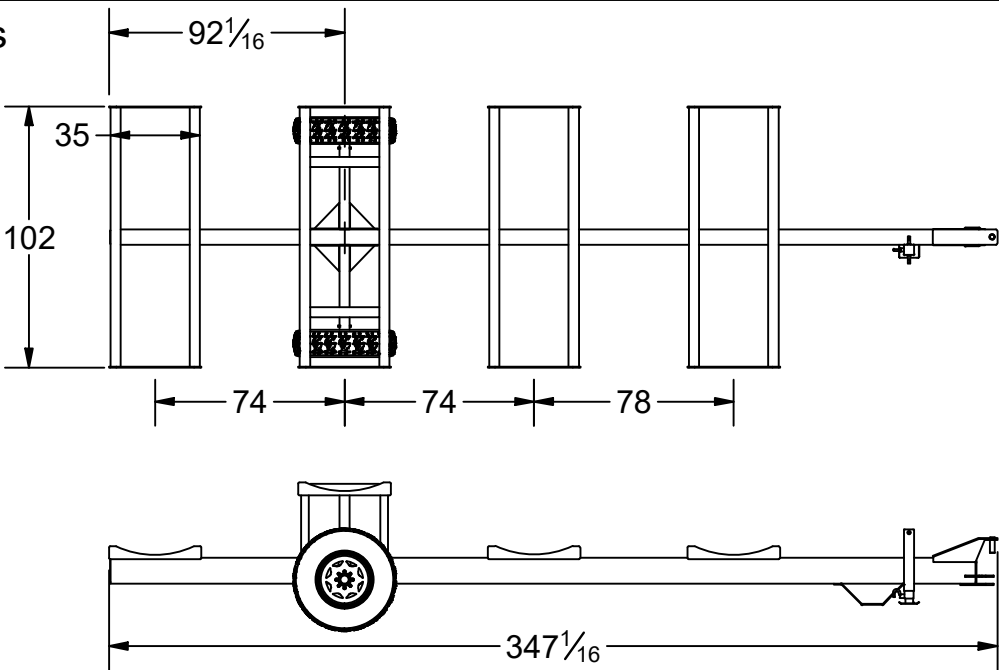

Bale Transporter Trolley 8 Bale Specifications

2840 lbs.

Tires: VF44565R22.5 Rear  
LT23585R16 Front

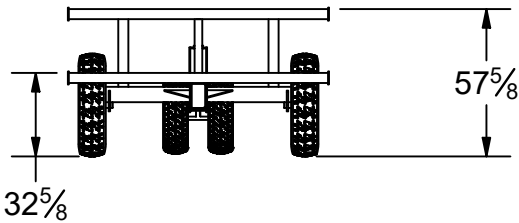
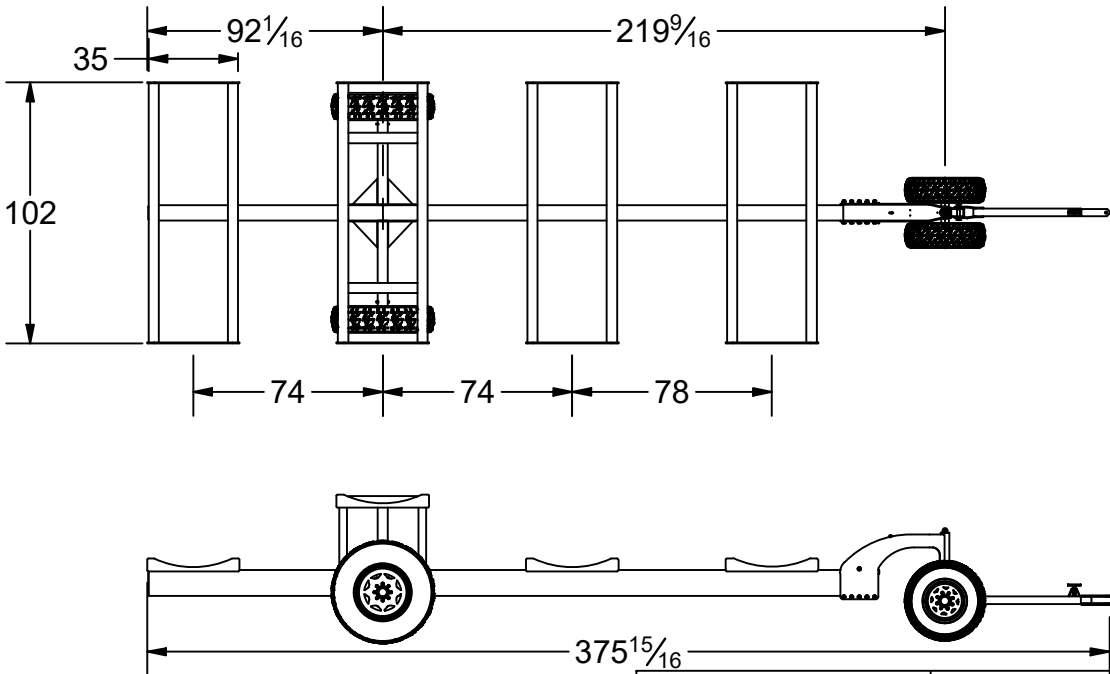

**Patriot Equipment**  
1302 K Road Minden, NE  
308-832-0220

This drawing, and the information hereon, are the property of Minden Machine Shop Inc., and may be used only as authorized by us. Unpublished - All rights reserved under the copyright laws.

## Torque Data for Standard Nuts, Bolts, and Capscrews

Tighten all bolts to torques specified in chart unless otherwise noted. Check tightness of bolts periodically, using bolt chart as guide. Replace hardware with same grade bolt.

Note: Unless otherwise specified, high-strength Grade 5 hex bolts are used throughout assembly of equipment.

**Bolt Torque for Standard Bolts**

Bolt Size A	Grade 2		Grade 5		Grade 8	
	lb-ft	(N.m)	lb-ft	(N.m)	lb-ft	(N.m)
1/4"	6	8	9	12	12	16
5/16"	10	13	18	25	25	35
3/8"	20	27	30	40	45	60
7/16"	30	40	50	70	80	110
1/2"	45	60	75	100	115	155
9/16"	70	95	115	155	165	220
5/8"	95	130	150	200	225	300
3/4"	165	225	290	390	400	540
7/8"	170	230	420	570	650	880
1"	225	300	630	850	970	1310

Torque figures indicated are valid for non-greased or non-oiled threads and heads unless otherwise specified. Therefore, do not grease or oil bolts or capscrews unless otherwise specified in this manual. When using locking elements, increase torque values by 5%.

**Bolt Torque for Metric Bolts**

Bolt Size A	Class 8.8		Class 9.8		Class 10.9	
	lb-ft	(N.m)	lb-ft	(N.m)	lb-ft	(N.m)
6	9	13	10	14	13	17
7	15	21	18	24	21	29
8	23	31	25	34	31	42
10	45	61	50	68	61	83
12	78	106	88	118	106	144
14	125	169	140	189	170	230
16	194	263	216	293	263	357
18	268	363	..	..	364	493
20	378	513	..	..	515	689
22	516	699	..	..	702	952
24	654	886	..	..	890	1206

Grade or Class value for bolts and capscrews are identified by their head markings.

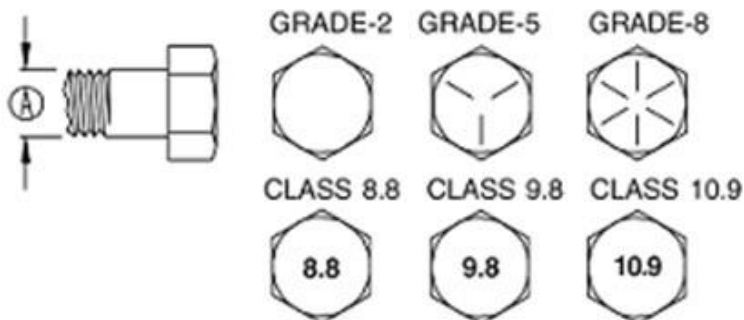

## Setup

The Bale Transporter should arrive fully assembled. Depending upon shipping, the tires may have to be mounted. Please follow the torque requirements if mounting the tires. The use of a correctly sized tow vehicle will be required. The Bale Transporter is heavy when it is fully loaded so a tow vehicle is required that can carry the load as well as provide the stopping power.

Before using the Bale Transporter:

- Inspect for any broken or cracked welds
  - Repair any that are found
- Inspect hitch for any defects
  - Replace if defects are found
- Inspect wheel bearings
  - Are the bearings loose – tighten if necessary
  - Does the wheel spin easily?
- Inspect tires for wear or cracks
  - Replace as needed
- Are the tires/rims tight on the hub?
  - Tighten if necessary

## Towing

The Bale Transporter has a clevis style hitch that requires the correct pin when coupling to the tow vehicle. The two wheel versions of the Bale Transporter have a quick hitch mechanism as well as the traditional clevis style hitch. The quick hitch mechanism requires the correct quick hitch for the tow vehicle so that it will work correctly and safely. The maximum tow speed of the Bale Transporter is 25 mph. Depending upon where the Bale Transporter is used, the operator may need to install lights to use on the Bale Transporter. Operators need to check the local codes for illumination requirements for trailers.

## Operation

Place the Bale Transporter on a flat level surface. The Bale Transporter should never be placed on a slope as this may cause it to move uncontrolled on its own which could lead to a severe injury or death. The tow vehicle may remain coupled to the Bale Transporter while it is being loaded/unloaded or it may not be attached depending upon the operational setup. Some operators will have the tow vehicle serve as the loading/unloading vehicle as well. While other operations will use a separate tow vehicle and loading/unloading vehicle.

When loading the Bale Transporter, load the area in front of the axle first. Loading in this area will distribute the weight correctly and not cause the Bale Transporter to tip rearward. Complete loading the Bale Transporter with the correct number of bales depending upon the model (either six or eight bales). If necessary, attach the tow vehicle back to the Bale Transporter. Transport the bales to their desired location and offload the bales in the reverse order they were loaded. Repeat the processes until the desired quantity of bales are transported.



## **Danger!**

**While loading/unloading bales from the Bale Transporter, establish a work area that no one is allowed to enter to prevent a serious injury or death. Serious injury or death could result if someone is struck by the loading/unloading vehicle.**

### **Service/Maintenance**

Maintenance required for the Bale Transporter:

- Lubricate the wheel bearings every 100 hrs. of use
- Inspect wheel hubs and bearings annually
  - Are the hubs loose on the spindle?
  - Do the bearings move easily?
  - Remove the hubs and clean and inspect the bearings
    - Repack the bearings
  - Reinstall the hubs and bearings and tighten correctly
- Inspect the frame for any defects
  - Repair any that are found
- Inspect the hitch for any defects
  - Replace parts that are defective
- Inspect the jack for correct operation
  - Lubricate the jack mechanism
- Use touch up paint on any areas where the paint has worn off



## Wheel Attachment and Torque Requirements

Patriot Equipment would like to reiterate the extreme importance of properly matching your axles, wheels, and tires when specifying or replacing your trailer wheels. It is of equal importance that you apply and maintain proper wheel mounting torque on your trailer axle. Please follow the wheel selection, torque requirement, and torque sequence guidelines that follow.

### Wheel Selection

Wheels are a very important and critical component of your running gear system. When specifying or replacing your trailer wheels it is important that the wheels, tires, and axle are properly matched. The following characteristics are extremely important and should be thoroughly checked when replacement wheels are considered.

1. **Bolt Circle:** Many bolt circle dimensions are available and some vary by so little that it might be possible to attach an improper wheel that does not match the axle hub. Be sure to match your wheel to the axle hub, bolts circle, hub pilot and wheel mount surface to hub face. Also, confirm that proper studs stick out.
2. **Capacity:** Make sure that the wheels have enough load carrying capacity and pressure rating to match the maximum load of the axle tire and trailer.
3. **Offset:** This refers to the relationship of the center line of the tire to the hub face of the axle. Care should be taken to match any replacement wheel with the same offset wheel as originally equipped. Failure to match offset can result in reducing the load carrying capacity of your axle.
4. **Rim Contour.**



### CAUTION

Replacement tires must meet the same specifications as the originals. Mismatched tires and rims may come apart with explosive force and cause personal injury to yourself and others. Mismatched tires and rims can also blow out and cause you to lose control and have an accident which can result in serious injury or death.



### CAUTION

Do not attempt to repair or modify a wheel. Even minor modifications can have a great effect. Do not install a tube to correct a leak through the rim. If the rim is cracked, the air pressure in the tube may cause the pieces of the rim to explode with great force and can cause serious injury or death.

### Torque Requirements

You should always consult with the wheel manufacturer to determine the appropriate torque level for your wheels. It is extremely important to apply and maintain proper wheel mounting torque on your trailer axle. Torque is a measure of the amount of tightening applied to a fastener (nut or bolt) and is expressed as length times force. For example, a force of 90 pounds applied at the end of a wrench one foot long will yield 90 Ft Lbs. of torque. Torque wrenches are the proper method to ensure torque is applied correctly to a fastener.



## CAUTION

**Wheel nuts or bolts must be tightened and maintained at the proper torque levels to prevent loose wheels, broken studs, and possible dangerous separation of wheels from your axle, which can lead to an accident, personal injuries or death.**

Be sure to use only the fasteners matched to the cone angle of your wheel (usually 60 degrees or 90 degrees). The proper procedure for attaching your wheels is as follows:

1. Start all nuts/bolts by hand to prevent cross threading.
2. The tightening should be done in stages;
  - a. Initially snug (10 ft-lb) the nuts/bolts to align and seat the wheel to the hub, in the order described in the torque sequence diagram below.
  - b. Tighten the nuts/bolts performing the wheel torque sequence below.
3. Wheel nuts/bolts should be torqued before first road use and after each wheel removal. Check and re-torque after the first 10 miles, 25 miles and again at 50 miles. Check periodically thereafter, THIS IS VERY IMPORTANT.
4. Wheel nuts are designed to have full thread engagement with the wheel stud. Wheel stud threads should be visible outside the wheel nut. There will be varying amounts of thread stick out depending on variables such as center disc thickness and nut thickness. In general, there should be approximately three threads visible past the end of the nut.

## Wheel Attachment and Torque Requirements

Wheel Installation Torque Sequence (Ft. Lbs.)					
Wheel Size	Stud Size	1st Stage	2nd Stage	Final Torque	Cone Nut Degree
12" - 440 BC	1/2"-20	20-25	35-40	60-75	60 Degree Cone Nut
12" - 545 BC	1/2"-20	20-25	35-40	60-75	60 Degree Cone Nut
13" - 440 BC	1/2"-20	20-25	35-40	60-75	60 Degree Cone Nut
13" - 545 BC	1/2"-20	20-25	35-40	60-75	60 Degree Cone Nut
14" - 545 BC	1/2"-20	20-25	50-60	100-120	60 Degree Cone Nut
15" - 545 BC	1/2"-20	20-25	50-60	100-120	60 Degree Cone Nut
15" - 655 BC	1/2"-20	20-25	50-60	100-120	60 Degree Cone Nut
16" - 655 BC	1/2"-20	20-25	50-60	100-120	60 Degree Cone Nut
16" - 865 BC	9/16"-18	20-25	50-60	140-170	60 Degree Cone Nut
16.5" - 655 BC	1/2"-20	20-25	50-60	100-120	60 Degree Cone Nut
16.5" - 865 BC	9/16"-18	20-25	50-60	140-170	60 Degree Cone Nut
16.5" x 9.75" 865 BC	5/8"-18	50-60	120-125	175-225	Special Stud Piloted with 90 degree Cone Nuts
17.5" Hub Pilot 865 BC	5/8"-18	50-60	100-120	190-210	Hub piloted with clamp ring. 90 degree cone nuts and greased threads.
17.5" Hub Pilot 865 BC	5/8"-18	50-60	90-200	275-325	Hub piloted with flange nut
17.5" Hub Pilot 865 BC	5/8"-18	50-60	60-110	150-175	Hub piloted with swivel flange nut

Medium and Heavy Duty Torque Requirements (Ft. Lbs.)				
Description	Part Number	Application	Torque Min. Ft. Lbs.	Torque Max. Ft. Lbs
5/8-19 90 degree Cone	006-109-00	Clamp Ring 033-052-01	190	210 Grease Threads
3/4-10 Hex Nut	006-117-00	Demountable Rim Clamp	210	260
3/4-16 Spherical Nut	006-064-01, 02 006-069-01, 02	Single Wheel Inner Dual	450 450	500 500
1-1/8 - 16 Spherical Nut	006-070-01, 02	Outer Dual	450	500
5/8-18 Non-swiveling Flange Nut	006-058-00	Wheels	275	325
5/8-18 Swiveling Flange Nut	006-209-00	Wheels	150	175
M22-1.5	006-118-00	Swiveling Flange Nut	450	500

**Minden Machine Shop Inc.**  
1302 K Road Minden, NE  
800-264-6587 / 308-832-0220

## Torque Sequence

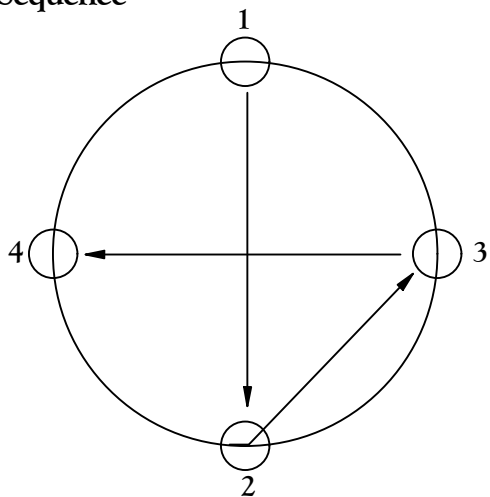

4 Bolt

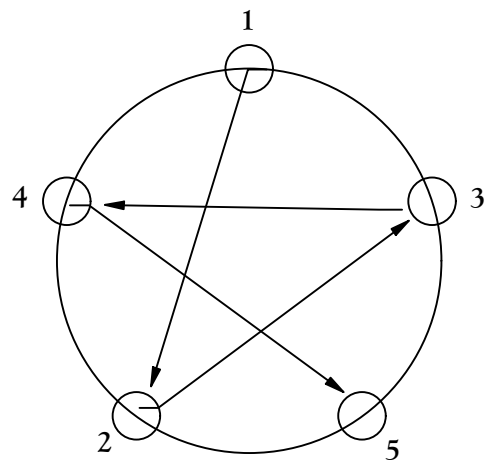

5 Bolt

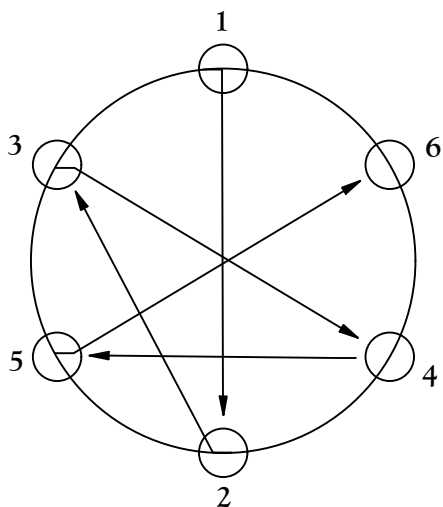

6 Bolt

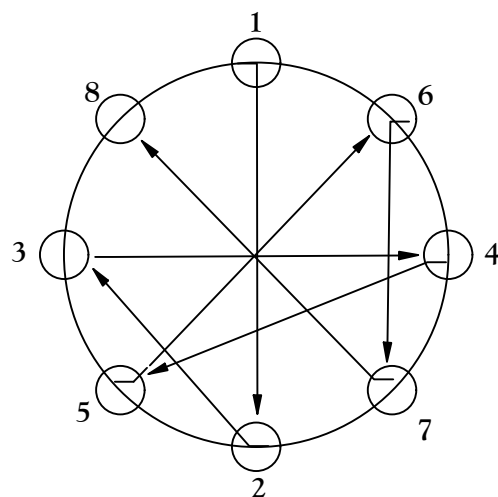

8 Bolt

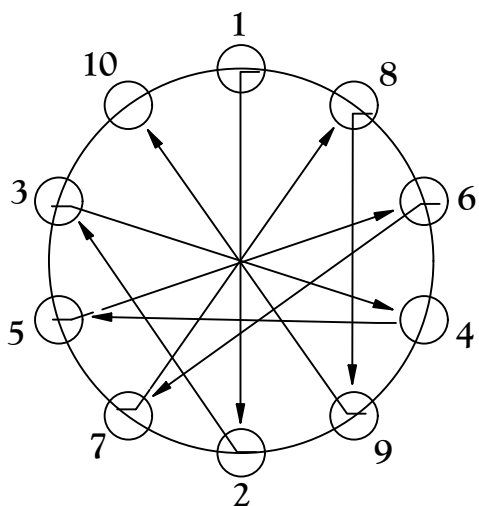

10 Bolt

# Parts Diagrams

# Bale Transporter Trolley Style Hub and Bearings

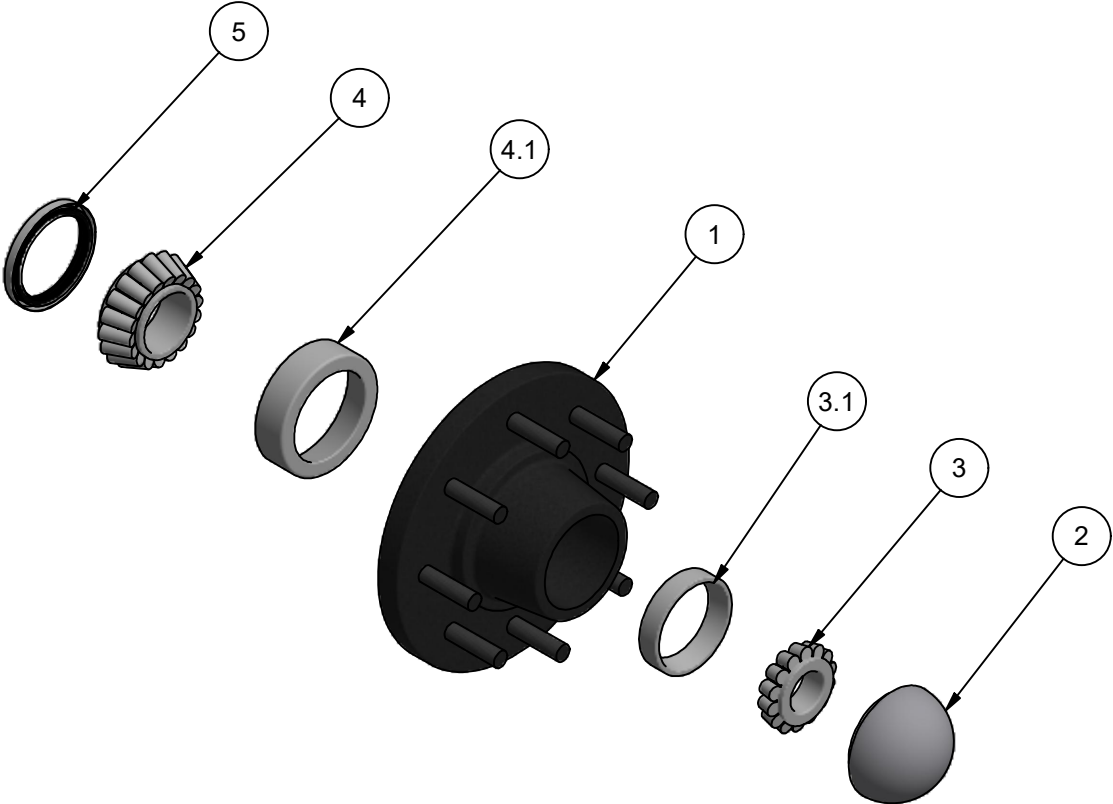

8 Bolt Hub  
3500# Rating

Parts List			
ITEM	QTY	PART NUMBER	DESCRIPTION
1	1	82865A-1	8 on 6.5" Hub
2	1	1605	Hub Cap
3	1	14125A	Outer Bearing
3.1	1	14276	Outer Cup (Race)
4	1	25580	Inner Bearing
4.1	1	25520	Inner Race
5	1	22333TBN	Seal

**Patriot Equipment**  
1302 K Road Minden, NE  
308-832-0220

This drawing, and the information hereon, are the property of Minden Machine Shop Inc., and may be used only as authorized by us. Unpublished - All rights reserved under the copyright laws.

Bale Transporter Hub and Bearings (Two Wheel Models)

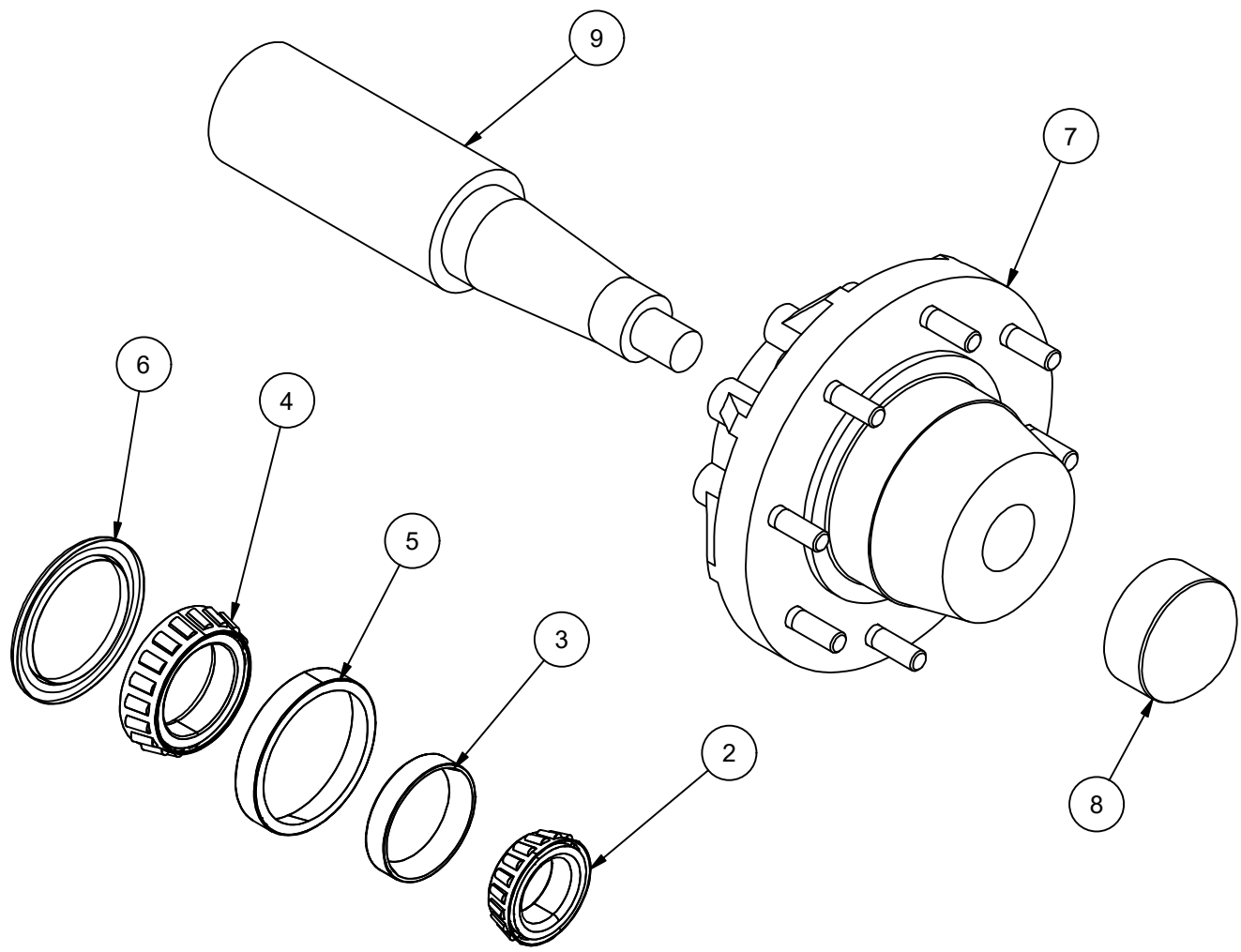

10 Bolt Hub  
12K Rating

Parts List

ITEM	QTY	PART NUMBER	DESCRIPTION
2	1	SPD871-5 (460)	Outer Bearing
3	1	SPD871-4 ((453A)	Outer Race
4	1	SPD871-3 (39585)	Inner Bearing
5	1	SPD871-2 (39520)	Inner Race
6	1	SPD871-1 (906497)	Seal
7	1	N871	Hub
8	1	SPD871-6 (909983)	Cap
9	1	SPD871-7 (G28197L17.375)	Spindle
10	1	SPD871	Complete Hub and Spindle

**Minden Machine Shop Inc.**  
1302 K Road Minden, NE  
308-832-0220

## California Proposition 65

The Safe Drinking Water and Toxic Enforcement Act of 1986 (California Proposition 65, commonly known as Prop 65) applies to companies doing business in the State of California. The regulation is administered by the Office of Environmental Health Hazard Assessment (OEHHA) and mandates that no person in the course of doing business shall knowingly expose any individual to a chemical known to the State of California to cause cancer and/or reproductive toxicity without first giving clear and reasonable warning to individuals. If the business can prove that the exposure level poses no significant risk to the end consumer no warning is necessary.

Minden Machine Shop, Inc. is providing the information below to educate about the chemicals that are or could be found in the products that Minden Machine Shop, Inc. produces or uses in their products.

Material	Chemical	CAS #	Cancer, Reproductive Harm or Both?
Cast Iron	Nickel	7440-02-0	Cancer
	Arsenic	7440-38-2	Both
	Cobalt	7440-48-4	Cancer
	Lead	7439-92-1	Both
Steel	Nickel	7440-02-0	Cancer
Stainless Steel	Nickel	7440-02-0	Cancer
Paint Finishes	Carbon Black	1333-86-4	Cancer
	Toluene	108-88-3	Reproductive Harm
	Lead	7439-92-1	Both
Rubber Compounds	Acrylonitrile	107-13-1	Cancer
	Butadiene	106-99-0	Both
	DEHP	117-81-7	Both
EPDM	Carbon Black	1333-86-4	Cancer
Petroleum	Cadmium	-----	Both
Petroleum	Isoprene	78-79-5	Cancer

Additional information on Proposition 65 can be obtained by visiting the State of California's Proposition 65 website:

<https://oehha.ca.gov/proposition-65/about-proposition-65>

Summary of Proposition 65 requirements:

<https://oehha.ca.gov/proposition-65/general-info/proposition-65-plain-language>

Clear and reasonable notice requirements:

<https://oehha.ca.gov/proposition-65/cnr/notice-adoption-article-6-clear-and-reasonable-warnings>

Chemicals and substances regulated by Proposition 65:

<https://oehha.ca.gov/proposition-65/proposition-65-list>

Proposition 65 Laws and Regulations:

<https://oehha.ca.gov/proposition-65/law/proposition-65-law-and-regulations>



Minden Machine Shop, Inc. has placed this decal on our products to alert the user to the possible exposures.

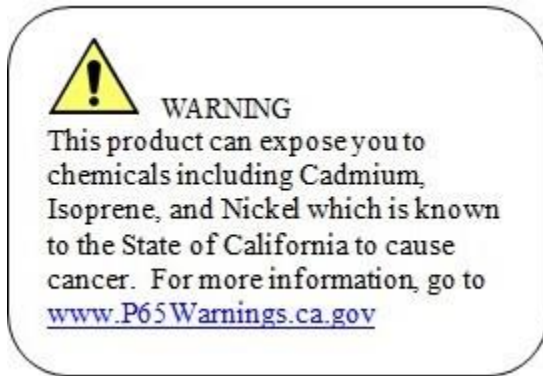

# Minden Machine Shop Inc

## LIMITED WARRANTY

Minden Machine Shop Inc warrants all products manufactured by it to be free of defect in material and workmanship for a period of one (1) year from the date of purchase.

This Minden Machine Shop Inc. warranty does not cover:

1. Parts and accessories supplied by Minden Machine Shop Inc. but manufactured by others. Minden Machine Shop Inc. will facilitate the other manufacturer warranty for the benefit of the purchaser but will not be bound thereby (example: augers, motors, trailers, tanks, etc.).
2. Products that have been altered by anyone other than a Minden Machine Shop Inc. employee or are used by the purchaser, for purposes other than what was intended at time of manufacture or used in excess of the "built specifications".
3. Products that are custom manufactured by Minden Machine Shop Inc. utilizing the purchaser's design which deviates from Minden Machine Shop Inc. normal production line manufactured or customized features of the products.
4. Malfunctions or damages to the product from misuse, negligence, customer alteration, accidents or product abuse due to incoming material or poor material flow ability or lack of required performance or required maintenance (e.g., poor material flow ability caused by incoming wet fertilizer or hot soybean meal, etc).
5. Loss of time, inconvenience, loss of material, down time or any other consequential damage.
6. Product use for a function that is different than designed intent (e.g., storing soybean meal in grain bin, unacceptable material in the bin such as hot bean meal when product originally designed for other application, etc).
7. Minden Machine Shop Inc is not responsible for any equipment that this product is attached to or mounted on.

To activate this warranty, the purchaser must make contact in writing with Minden Machine Shop Inc. within one (1) year of date of purchase. After contact, Minden Machine Shop Inc. has the right to determine the cause and qualify the legitimacy of the claim. Minden Machine Shop Inc., upon acceptance of a warranty claim, shall have a reasonable time to plan any repair or replacement and may affect repair or replacement out of its factory or through contract with a local repair service. If a purchaser after warranty notice is made, chooses to make the repair itself, Minden Machine Shop Inc. must approve any expenses before they are incurred to be responsible for customer reimbursement. Minden Machine Shop Inc. shall be liable on a warranty claim for repair or replacement of any defective products and this is the purchaser's sole and exclusive remedy. Minden Machine Shop Inc. will not be liable for any other or further remedy including claims for personal injury, property damage or consequential damage. The law of the State of Nebraska shall govern and any such claim and any issues with regard to the same shall be resolved in the Nebraska District Court for the county of Kearney.

## RETURN OF MERCHANDISE

Merchandise may not be returned without written approval from the factory. All returns must have a return authorization number. Obtain this number before the return and show it on all return items. A 15% restocking charge is made on merchandise returned. Returned merchandise must be shipped pre-paid.

## RECEIVING MERCHANDISE AND FILING CLAIMS

When receiving merchandise it is important to check both the number of parts and their description with packing slip. The consignee must make all claims for freight damage or shortage within 10 days from the date of delivery.

When the material leaves the factory it becomes the property of the consignee. It is the responsibility of the consignee to file a claim on any possible damage or loss. Please list your preferred routing on purchase orders.

## MODIFICATIONS

It is the policy of Minden Machine Shop Inc. to improve its products whenever possible and practical to do so. We reserve the right to make changes, improvements and modifications at any time without incurring the obligation to make such changes, improvements and modifications on any equipment sold previously.

# WARRANTY REGISTRATION

To register equipment, or file a claim, copy and paste the words on this page into an email or word document, fill out the appropriate information completely, and email it to [larry@mindenmachine.com](mailto:larry@mindenmachine.com) with the subject as EQUIPMENT WARRANTY, or fill it out and fax it to 308-832-1340.

**Dealer Information:**

Not Applicable, check here: [   ]

Dealer Name:

Address:

City:

State:

Zip Code:

Phone #:

Email:

**End User Information:**

Purchaser:

Address:

City:

State:

Zip Code:

Phone #:

Email:

Equipment:

Serial #:

Date Of Purchase:     /     /

Equipment:

Trailer Model Number:

Trailer VIN Number:

Date Of Purchase:     /     /

Dealer Name:

**TIRE IDENTIFICATION NUMBERS**

QTY	1	2	3	4	5	6	7	8	9	10	11	12
1												
2												
3												
4												
5												
6												
7												
8												

**Please return within 14 days of purchase**

# CLAIM FILE

**Defect:**