

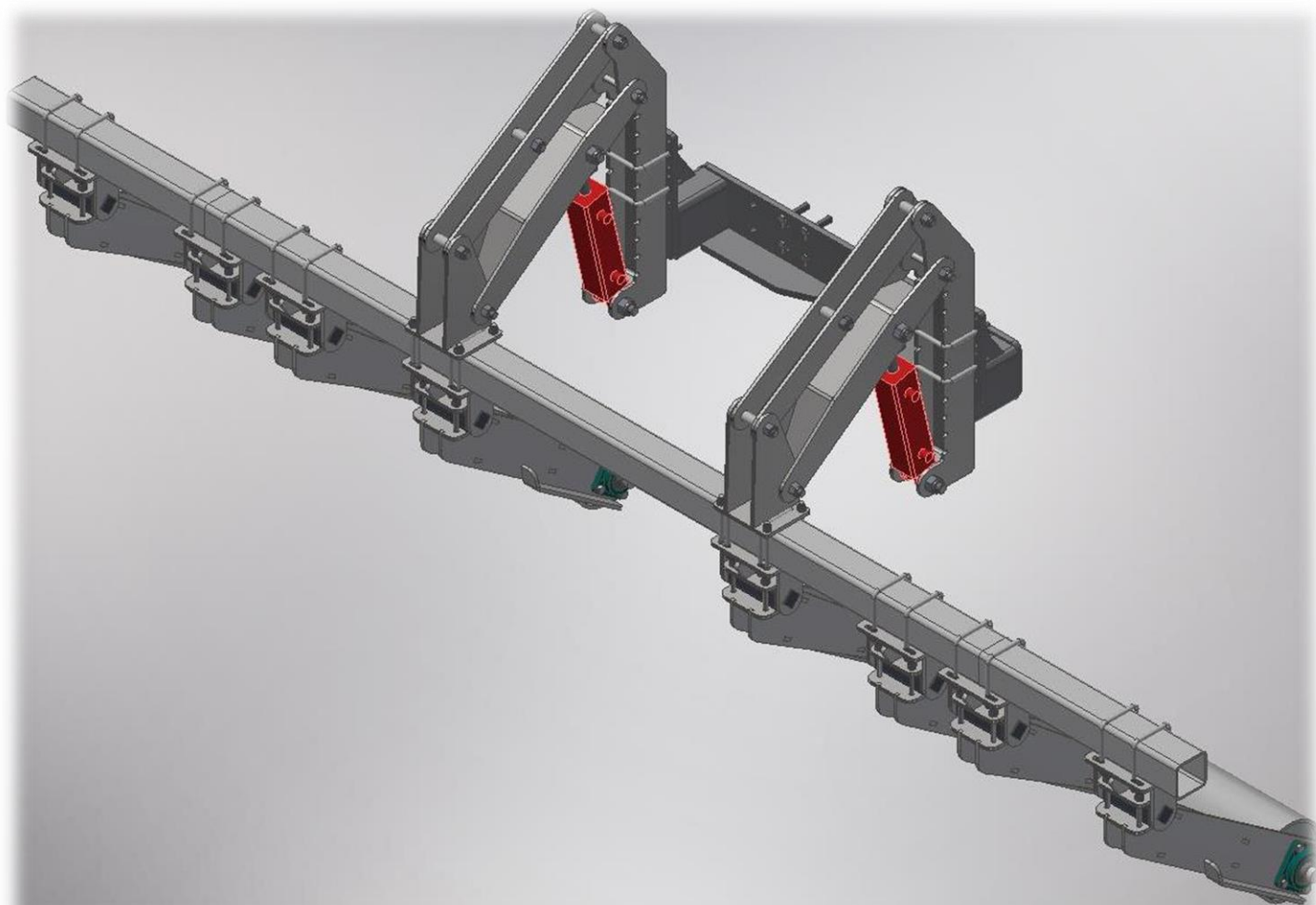

## **Patriot Stubble Crusher**

### **Owner's Manual**



**Manufactured by  
Minden Machine Shop Inc.  
1302 K Road  
Minden NE 68959  
1-308-832-0220**

# Table of Contents

Introduction	3
Safety and Operation Rules	4
Safety Decals	8
Bolt Torque Table	10
Stubble Crusher Mounts	11
Stubble Crusher Parallel Links	14
Stubble Crusher Shoes	15
Stubble Crusher Rollers	17
Stubble Crusher Hydraulics	19
Setup and Operation	20
Optional Equipment	22
California Proposition 65	23
Warranty	25
Installation Guide	27

# INTRODUCTION

Thank you for purchasing a Patriot Equipment product! We know you will get many years of productive use from it. The product has been designed to assist in the protection of agricultural tires from crop residue stalks and stems. All product users must read and understand this manual prior to equipment operation. This manual is considered part of your machine and should remain with the machine at all times. Do not allow anyone to operate or maintain this equipment if they have not fully read and comprehended this manual. Failure to follow the recommended procedures may result in personal injury or death or equipment damage.

Information in this manual is designed to help owners and operators to obtain the best results and safe operation from their investment. The life of any machine depends largely on the care it is given and we suggest that the manual should be read and understood and referred to frequently. If for any reason you do not understand the instructions and safety requirements, please contact your authorized dealer. The intent of this manual is to provide guidelines to cover general use and to assist in avoiding accidents and injuries.

There may be times when circumstances occur that are not covered in the manual. At those times it is best to use common sense and contact your authorized dealer or our factory.

The requirements of safety cannot be emphasized enough in this publication. We urge you to make safety your top priority when using and maintaining the equipment. We strongly advise that anyone allowed to operate this equipment be thoroughly trained and tested, to prove they understand the fundamentals of safe operation.

Some photographs, diagrams or illustrations in this manual may show doors, guards and shields opened or removed to aid in clarity and understanding of a particular procedure. All guards, shields and safety devices must be in their proper position prior to operation.

# SAFETY AND OPERATION RULES

## General Safety Statements

Safety precautions are essential when the use of any mechanical equipment is involved. These precautions are necessary when using, storing, and servicing mechanical equipment. Using this equipment with the respect and caution demanded will considerably lessen the possibilities of personal injury. If safety precautions are overlooked or ignored, personal injury or property damage may occur.

The machine was designed for a specific application. It should not be modified and/or used for any application other than which it was designed. If there are any questions regarding its application, please write or call. Do not use this unit until you have been advised. For more information contact:

Patriot Equipment  
1302 K Rd  
Minden, NE 68959  
308-832-0220

Read this entire manual carefully. Know your equipment. Consider the application, limitations, and the potential hazards specific to your unit. Operator and bystander safety is of prime concern to us. This manual was written with the safety of the operator and others who come in contact with the equipment. This manual was written to help you understand the safe operating procedures of the product. We want you as our partner in safety. A copy of this manual should be available to all persons who may operate this machine.

It is your responsibility as an owner, operator, or supervisor to know what specific requirements, precautions, and work hazards exist and to make these known to all other personnel working with the equipment or in the area, so that they too may take any necessary safety precautions that may be required. Avoid any alterations of the equipment. Such alterations may create a dangerous situation where serious injury or death may occur and will void warranty.

Why is SAFETY important? Three reasons:

1. Accidents disable and kill
2. Accidents cost money
3. Accidents can be avoided

Note the use of the signal words **DANGER**, **WARNING**, and **CAUTION** with safety messages. The appropriate signal word for each message has been selected using the following guidelines:

**DANGER:** An immediate and specific hazard which will result in severe personal injury or death if proper precautions are not taken.

**WARNING:** A specific hazard or unsafe practice which could result in severe personal injury or death if proper precautions are not taken.

**CAUTION:** Unsafe practices which could result in personal injury if proper precautions are not taken or a reminder of good safety practices.

## Safety Alert Symbol



**BE ALERT! YOUR SAFETY IS INVOLVED!**

The symbol shown above is used to call your attention to instructions concerning your personal safety. Watch for this symbol – It points out important safety precautions. The symbol means: ATTENTION! BECOME ALERT! YOUR PERSONAL SAFETY IS INVOLVED! Read the message that follows and be alert to the possibility of personal injury or death.

Read this manual before operating or working around the equipment! This manual must be delivered with the equipment to its owner and operator. Failure to read this manual and its safety instructions is a misuse of equipment.

## Safety Equipment

Please, remember safety equipment provides important protection for persons around a machine that is in operation. Be sure ALL safety shields and protective devices are installed and properly maintained. If you find any shields or guards damaged or missing, contact Patriot Equipment for the correct items.

## Safety Procedures



1. Use only the correct equipment with the proper capacity when installing or removing the Stubble Crusher..
2. When installing the Stubble Crusher, create a work zone that limits the number of workers within, to prevent severe injury or death.
3. The Stubble Crusher will install easier with two workers, use good communication to coordinate mounting the Stubble Crusher to avoid severe injury or death.
4. Do not operate unit without safety shields or guards in place.
5. IMPORTANT: Use caution when transporting. Be alert of the transport unit's overall width when approaching obstacles, such as post sign and poles, along the road. Check the transport width of the unit to ensure clearance before entering.
6. Comply with all safety warnings and cautions in this manual as well as the operator's manuals of any tow vehicles that may be used.
7. Do not allow any riders on the Stubble Crusher.
8. The Stubble Crusher uses hydraulic fluid, never check for hydraulic fluid leaks using any part of the human body, use a piece of cardboard to check for hydraulic leaks.
9. Always raise the Stubble Crusher when operating in a reverse direction. Failure to do so will cause property damage and could result in severe injury or death.
10. In case of any defect or awareness of potential danger, please contact Patriot Equipment at 1-800-264-6587 immediately.

## Operator Qualifications



Operation of the Stubble Crusher shall be limited to competent and experienced persons. In addition anyone who will operate or work around the machine must use good common sense. In order to be qualified, they must also know and meet all other requirements, such as:

1. Some regulations specify that no one under the age of 18 may operate power machinery. It is your responsibility to know what these regulations are in your own area or situation.
2. Current Occupational Safety Health Administration regulations state in part: "At the time of initial assignment and at least annually thereafter, the employer shall instruct every employee or user in the safe operation and servicing of all equipment with which the employee or user is, or will be involved."
3. Unqualified persons are to stay out of the work area.
4. A person who has not read and understood all operating and safety instruction is not qualified to operate the machine.

## Safety Overview

YOU are responsible for SAFE operation and maintenance of the Stubble Crusher. YOU must ensure that you and anyone who is going to operate and maintain or work around the Stubble Crusher must be familiar with the operating, maintenance, and safety information contained in the manual.

Remember YOU are the key to safety. GOOD PRACTICES protect not only you but also the people around you. Make these practices a working part of your safety program. Be certain EVERYONE operating the Stubble Crusher is familiar with the procedures recommended and follows safety precautions. Remember, most accidents can be prevented. Do not risk injury or death by ignoring any information addressed.

Stubble Crusher owners must give operating instructions to operators before allowing them to operate the machine. They must be reviewed at least annually thereafter per OSHA regulation 1928.57.

The most important safety device on the equipment is a SAFE OPERATOR. It is the operator's responsibility to read and understand ALL instructions in the manual and to follow them. All accidents can be avoided!

Any person who has not read and understood all operation and safety instructions is not qualified to operate the machine. An untrained operator exposes himself and bystanders to possible serious injury or death.

Do not modify the equipment in any way. Unauthorized modifications may impair the functions and/or safety and could affect the life of the equipment.

## Safety Affirmation

1. I have read and understand the operator's manual and all safety signs before operation, maintenance, adjusting, or unplugging the machine.
2. I will allow only trained persons to operate the machine. \*An untrained operator is not qualified to operate this equipment.
3. I have access to a fire extinguisher.
4. I have all guards in place and will not operate the machine without them.
5. I will not allow riders on the machine.
6. I understand the danger of moving parts (rotating parts, hydraulics, and pinch points) and will stop engine before servicing.
7. I understand that any accidents that occur with the machine are my responsibilities.
8. I understand that Patriot Equipment will not be held responsible for any accidents that involve the machine.

## Sign Off Sheet

(This sheet should be signed annually as part of your safety program)

As a requirement of OSHA, it is necessary for the owner/employer to train the employee in the safe operation and safety procedures with this machine. We include this sign off sheet for your convenience and personal record keeping.

DATE	EMPLOYER SIGNATURE	EMPLOYEE SIGNATURE

## **Machine Inspection**

After delivery of the Stubble Crusher and/or completion of assembly, and before each use, inspection of the machine is mandatory. This inspection should include, but not be limited to:

1. Check to see that all guards are in place, secured and functional.
2. That all fasteners are tight.
3. That all hydraulic lines and hydraulic cylinders are:
  - a. Free from leaks – never check for leaks using any part of the human body as serious injury or death could occur.
  - b. No defects – no damage to hydraulic lines or cylinders
  - c. Hydraulic lines are mounted correctly and secured to keep free of damage.
4. That all shoes or rollers are in good working condition.
5. Inspect mounts and weldments for any cracks or damage.

## **Lighting and Marking**

It is the responsibility of the customer to know the lighting and marking requirements of the local highway authorities and to install and maintain the equipment to provide compliance with the regulations. Add extra lights when transporting at night or during periods of limited visibility if necessary.

## **Serial Number**

To ensure efficient and prompt service, please furnish us with the model and serial number of the machine in all correspondence or other contact. The serial number is located on a visible location of the machine.

## **Safety Decals**

1. Keep safety decals clear and legible at all times.
2. Replace decals and signs that are missing or have become unreadable.
3. Safety signs are available from your Dealer or the Manufacturer.

## **How to install Safety Decals**

1. Be sure that the installation area is clean and dry.
2. Decide on the exact position before you remove the backing paper.
3. Align the decal over the specified area and carefully press the small portion with the exposed sticky backing in place.
4. Slowly peel back the remaining paper and carefully smooth the remaining portion of the decal in place.
5. Small air pockets can be pierced with a pin and smoothed out using a piece of decal backing paper.



## Stubble Crusher Decal Location

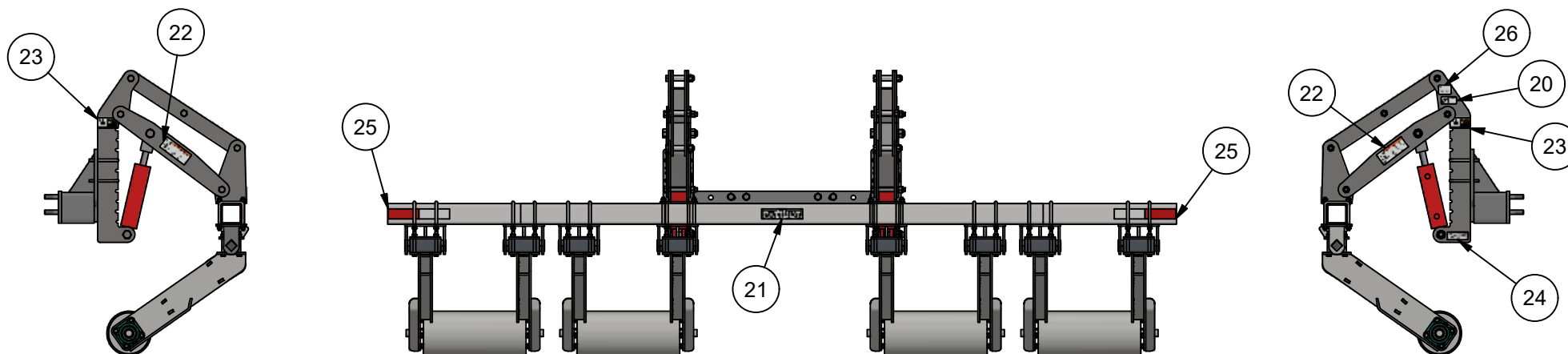

TS2017



TS2004



TS2012

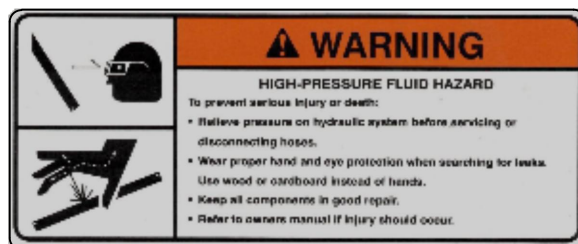

BC2515

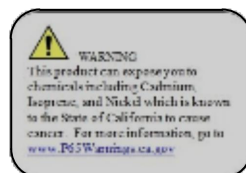

TS2018



TS2003

### Parts List

ITEM	QTY	PART NUMBER	DESCRIPTION
20	1	TS2017	Read Manual Before Use
21	1	TS2004	Patriot Decal
22	2	BC2515	Hydraulic Oil Warning
23	2	TS2012	Single Pinch Point
24	1	TS2003	Serial Number Decal
25	2	Stock DOT	Red/White Decal
26	1	TS2018	P65 California

**Patriot Equipment**  
1302 K Road Minden, NE  
308-832-0220

This drawing, and the information hereon, are the property of Minden Machine Shop Inc., and may be used only as authorized by us. Unpublished - All rights reserved under the copyright laws.

## Torque Data for Standard Nuts, Bolts, and Capscrews

Tighten all bolts to torques specified in chart unless otherwise noted. Check tightness of bolts periodically, using bolt chart as guide. Replace hardware with same grade bolt.

Note: Unless otherwise specified, high-strength Grade 5 hex bolts are used throughout assembly of equipment.

**Bolt Torque for Standard Bolts**

Bolt Size A	Grade 2		Grade 5		Grade 8	
	lb-ft	(N.m)	lb-ft	(N.m)	lb-ft	(N.m)
1/4"	6	8	9	12	12	16
5/16"	10	13	18	25	25	35
3/8"	20	27	30	40	45	60
7/16"	30	40	50	70	80	110
1/2"	45	60	75	100	115	155
9/16"	70	95	115	155	165	220
5/8"	95	130	150	200	225	300
3/4"	165	225	290	390	400	540
7/8"	170	230	420	570	650	880
1"	225	300	630	850	970	1310

Torque figures indicated are valid for non-greased or non-oiled threads and heads unless otherwise specified. Therefore, do not grease or oil bolts or capscrews unless otherwise specified in this manual. When using locking elements, increase torque values by 5%.

**Bolt Torque for Metric Bolts**

Bolt Size A	Class 8.8		Class 9.8		Class 10.9	
	lb-ft	(N.m)	lb-ft	(N.m)	lb-ft	(N.m)
6	9	13	10	14	13	17
7	15	21	18	24	21	29
8	23	31	25	34	31	42
10	45	61	50	68	61	83
12	78	106	88	118	106	144
14	125	169	140	189	170	230
16	194	263	216	293	263	357
18	268	363	..	..	364	493
20	378	513	..	..	515	689
22	516	699	..	..	702	952
24	654	886	..	..	890	1206

Grade or Class value for bolts and capscrews are identified by their head markings.

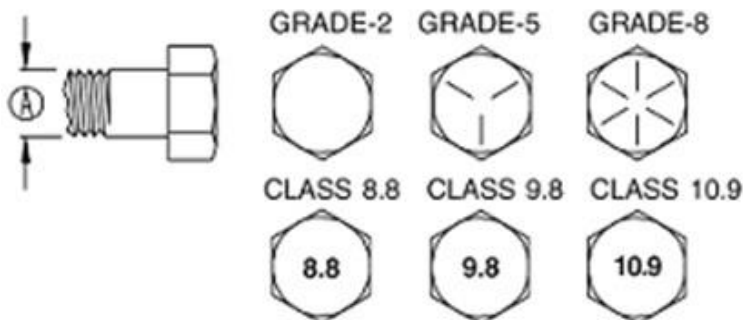

## Stubble Crusher Mounts for Case Tractors

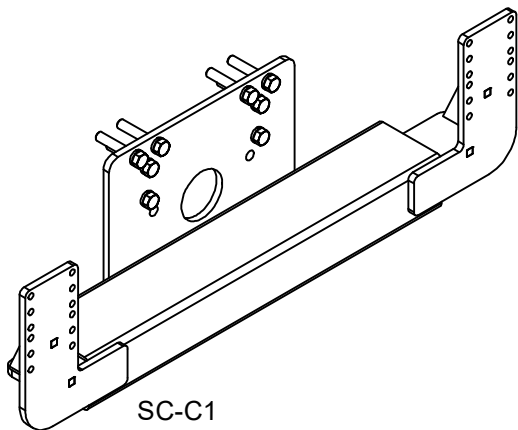

SC-C1  
Case 42" Weight Bracket

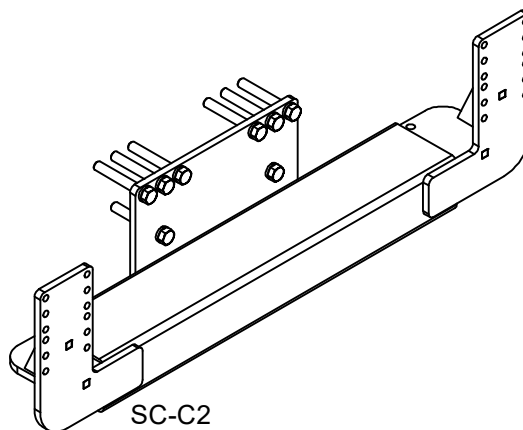

SC-C2  
Case Magnum  
235-340

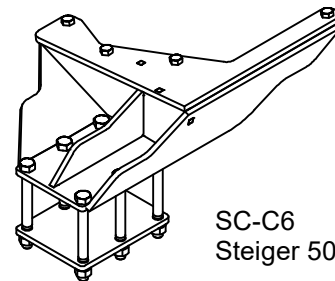

SC-C6  
Steiger 500-600

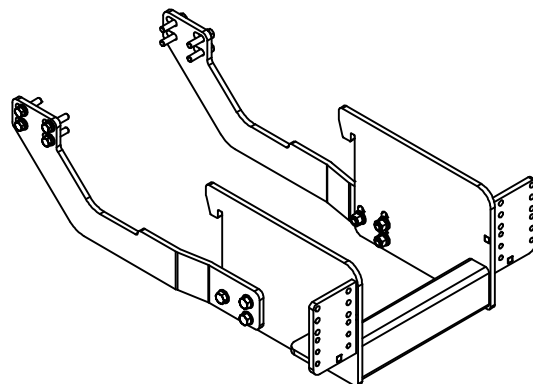
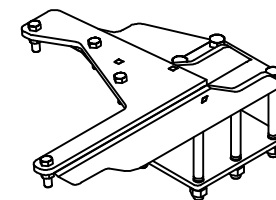

SC-C7  
IH Magnum 8910

**Patriot Equipment**  
1302 K Road Minden, NE  
308-832-0220

This drawing, and the information hereon, are the property of Minden Machine Shop Inc., and may be used only as authorized by us. Unpublished - All rights reserved under the copyright laws.

# John Deere Stubble Crusher Mounts

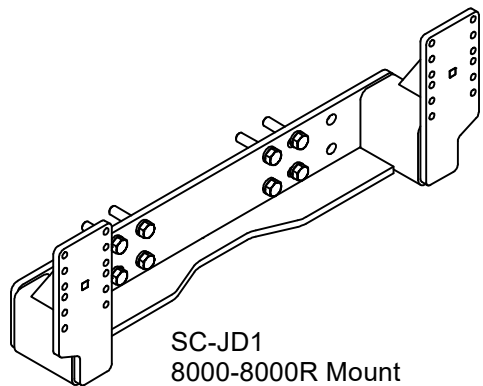

SC-JD1  
8000-8000R Mount

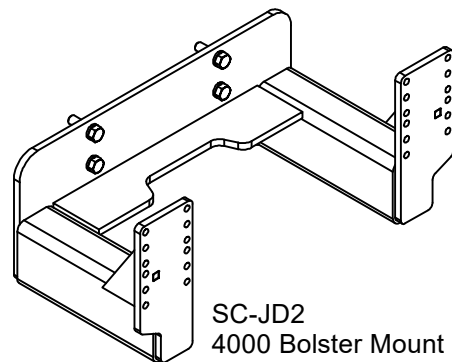

SC-JD2  
4000 Bolster Mount

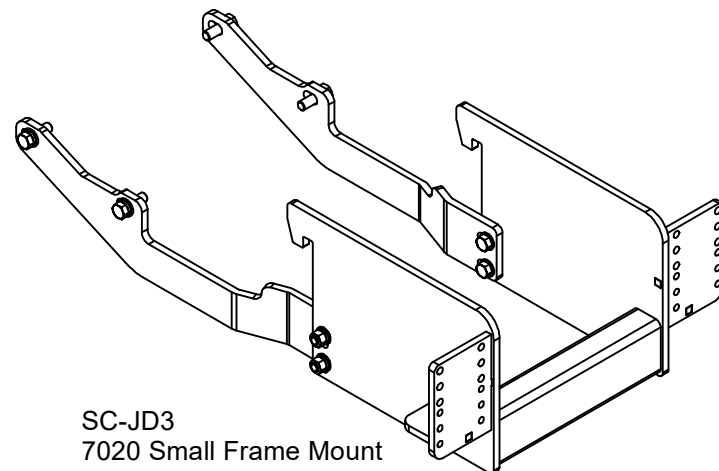

SC-JD3  
7020 Small Frame Mount

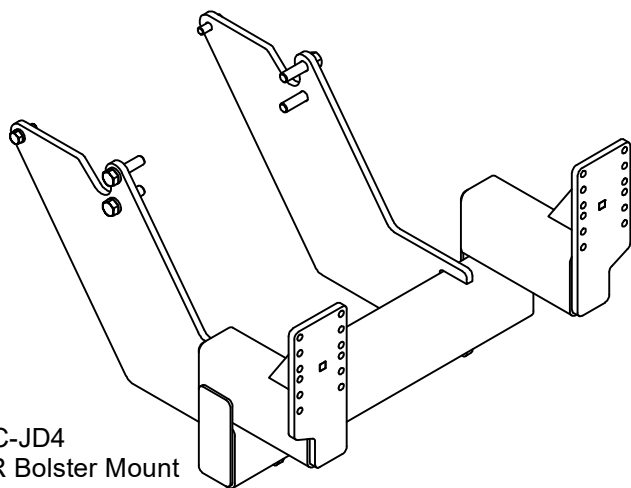

SC-JD4  
6R Bolster Mount

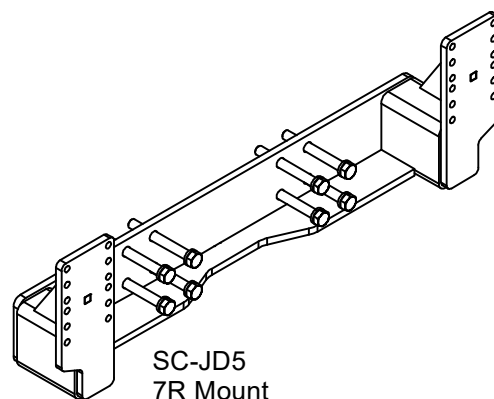

SC-JD5  
7R Mount

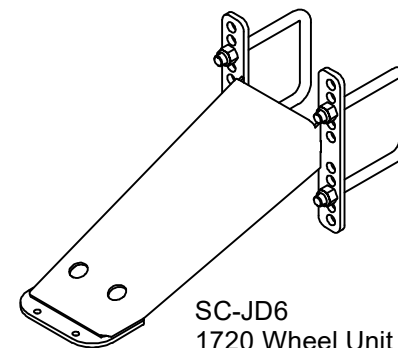

SC-JD6  
1720 Wheel Unit

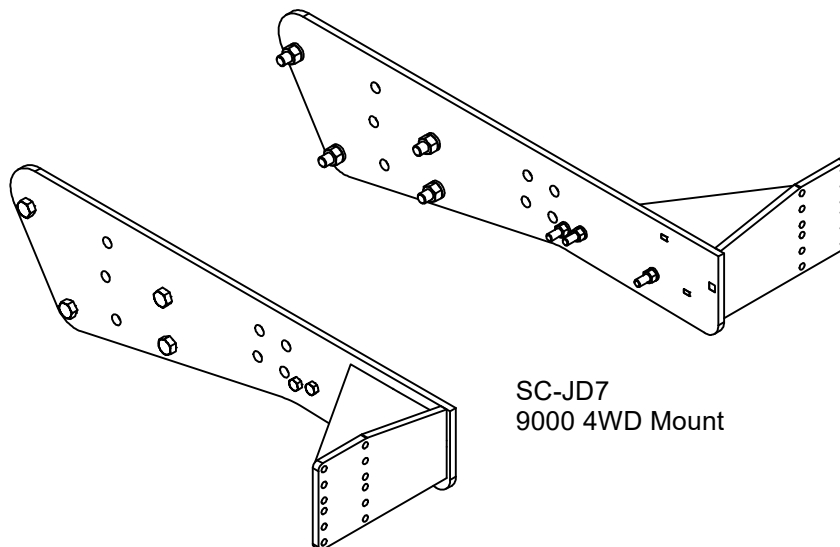

SC-JD7  
9000 4WD Mount

**Patriot Equipment**  
1302 K Road Minden, NE  
308-832-0220

This drawing, and the information hereon, are the property of Minden Machine Shop Inc., and may be used only as authorized by us. Unpublished - All rights reserved under the copyright laws.

# Universal Stubble Crusher Mount

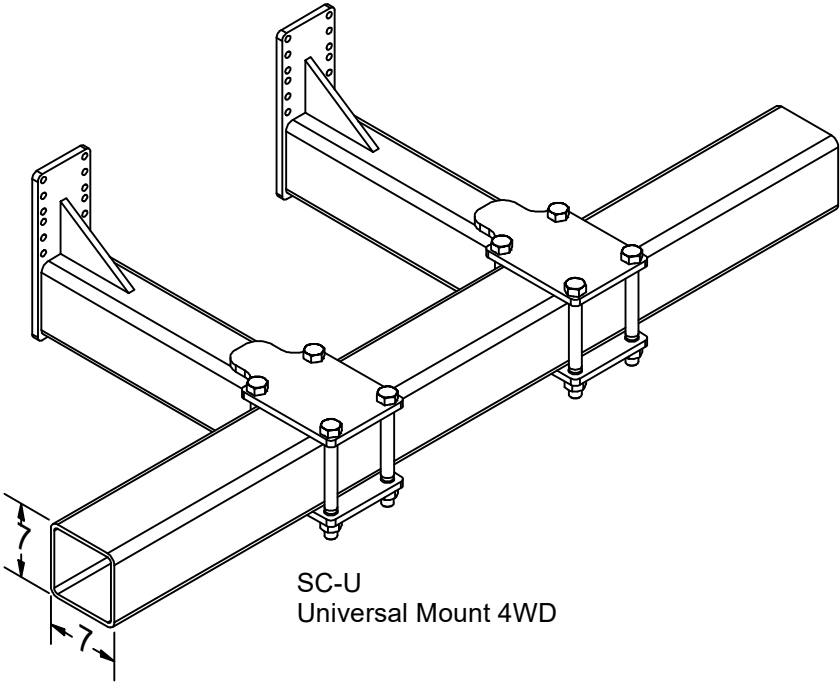

SC-U  
Universal Mount 4WD

**Patriot Equipment**  
1302 K Road Minden, NE  
308-832-0220

This drawing, and the information hereon, are the property of Minden Machine Shop Inc., and may be used only as authorized by us. Unpublished - All rights reserved under the copyright laws.

# Stubble Crusher Parallel Link Parts List

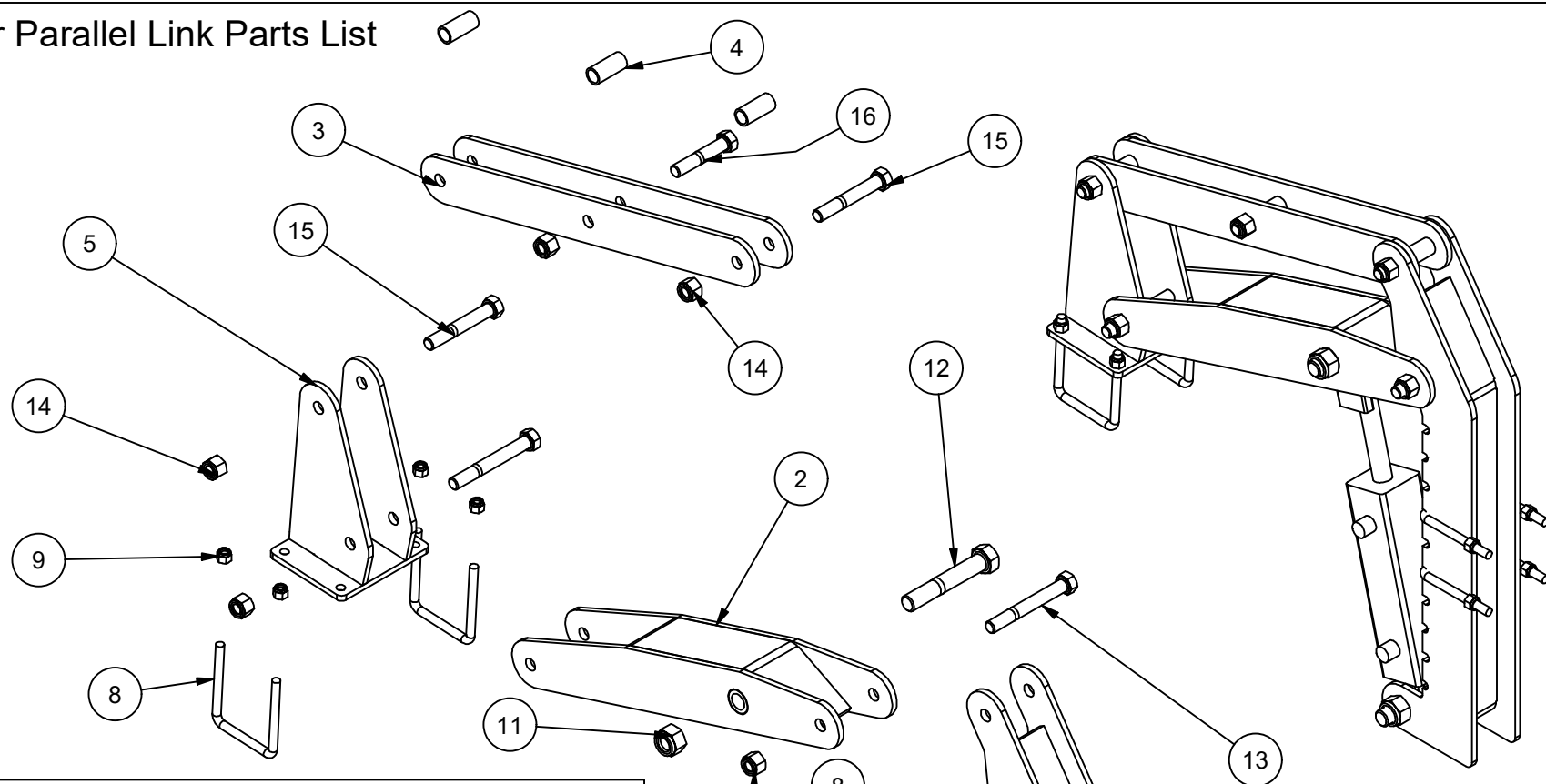

Parts List

ITEM	QTY	PART NUMBER	DESCRIPTION
1	2	SC-CP-A006	Radial Arm Vertical Adjustment Weldment
2	2	SC-CP-A008	Lower Linkage Arm Weldment
3	4	SC-CP-P019	Upper Linkage Bar Vertical Lift
4	6	SC-CP-P017	3_4 PST
5	2	SC-CP-A007	Lower Linkage Pivot Weldment
6	2	HCY1004	2.5 x 8 Hydraulic Cylinder
8	8	SCPPT1	1/2x4x5.25 SB U-Bolt
9	16	N1/2NYL	Nylock Nut
10	2	B1x5.5	Hex Bolt
11	4	N1NYL	Nylock Nut
12	2	B1x6	Hex Bolt
13	4	B3/4x6	Hex Bolt
14	10	N3/4NYL	3/4 Std NC Nylock Nut
15	4	B3/4x5	Hex Bolt
16	2	B3/4x4	Hex Bolt

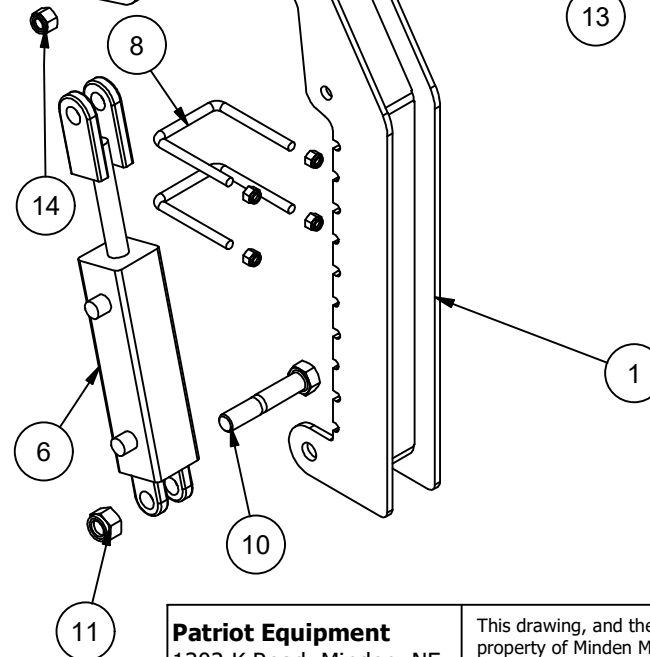

**Patriot Equipment**  
1302 K Road Minden, NE  
308-832-0220

This drawing, and the information hereon, are the property of Minden Machine Shop Inc., and may be used only as authorized by us. Unpublished - All rights reserved under the copyright laws.

Stubble Crusher Shoes

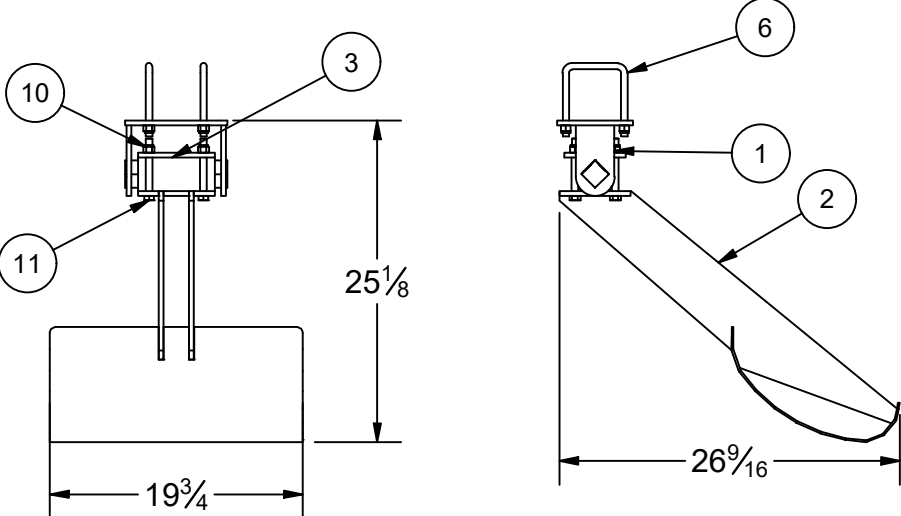

20" Stubble Crusher Shoe  
SC-CP-A011

Parts List			
ITEM	QTY	PART NUMBER	DESCRIPTION
1	1	SC-CP-A009	Torsion Shoe Rotater Weldment
2	1	SC-CP-A010	Long Arm Torsion Shoe 20 in Weldment
3	1	SC-CP-P023	Torsion Clamp Plate
6	2	SCPPT1	1/2x4x5.25 SB U-Bolt
10	8	N1/2NYL	Nylock Nut
11	4	B1/2x4.5	Hex Bolt

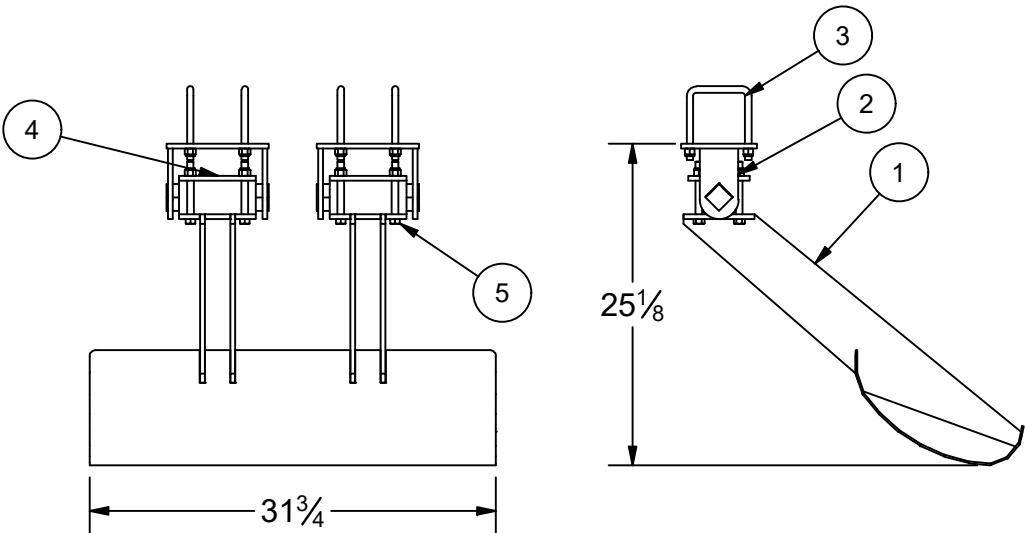

32" Stubble Crusher Shoe  
SC-CP-A017

Parts List			
ITEM	QTY	PART NUMBER	DESCRIPTION
1	1	SC-CP-A012	Long Arm Torsion Shoe 32 in Weldment
2	2	SC-CP-A009	Torsion Shoe Rotater Weldment
3	4	SCPPT1	1/2x4x5.25 SB U Bolt
4	2	SC-CP-P023	Torsion Clamp Plate
5	8	B1/2x4.5	Hex Bolt
6	16	N1/2NYL	Nylock Nut

**Patriot Equipment**  
1302 K Road Minden, NE  
308-832-0220

This drawing, and the information hereon, are the property of Minden Machine Shop Inc., and may be used only as authorized by us. Unpublished - All rights reserved under the copyright laws.

Stubble Crusher Shoes

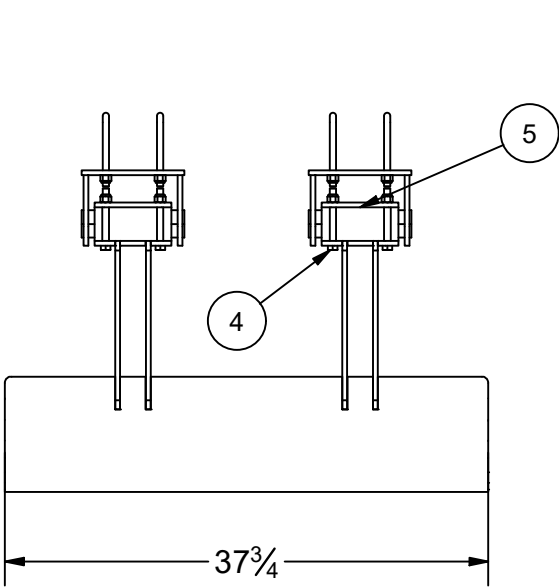

38" Stubble Crusher Shoe  
SC-CP-A018

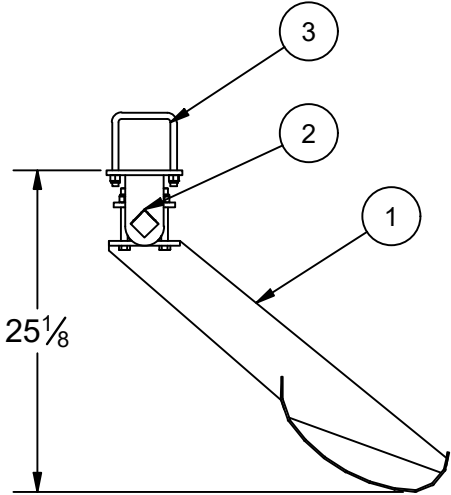

Parts List

ITEM	QTY	PART NUMBER	DESCRIPTION
1	1	SC-CP-A013	Long Arm Torsion Shoe 38 in Weldment
2	2	SC-CP-A009	Torsion Shoe Rotater Weldment
3	4	SCPPT1	1/2x4x5.25 SB U-Bolt
4	8	B1/2x4.5	Hex Bolt
5	2	SC-CP-P023	Torsion Clamp Plate
6	16	N1/2NYL	Nylock Nut

**Patriot Equipment**  
1302 K Road Minden, NE  
308-832-0220

This drawing, and the information hereon, are the property of Minden Machine Shop Inc., and may be used only as authorized by us. Unpublished - All rights reserved under the copyright laws.



## Stubble Crusher Roller Sizes

Parts List

ITEM	QTY	PART NUMBER	DESCRIPTION
1	1	SC-CP-A003	RH Arm Weldment
2	1	SC-CP-A005	LH Arm Weldment
3	1	SC-CP-A020	20 in Main Roller Weldment
4	2	SC-CP-A009	Torsion Shoe Rotater Weldment
5	2	BR1045	4 Bolt Flange Bearing
6	2	SC-CP-A004	Stopper Weldment
7	8	B1/2x4.5	Hex Bolt
8	24	N1/2NYL	1/2 Std NC Nylock Nut
9	4	SCPPT1	1/2x4x5.25 SB U-Bolt
12	8	B1/2x1.5	Hex Bolt

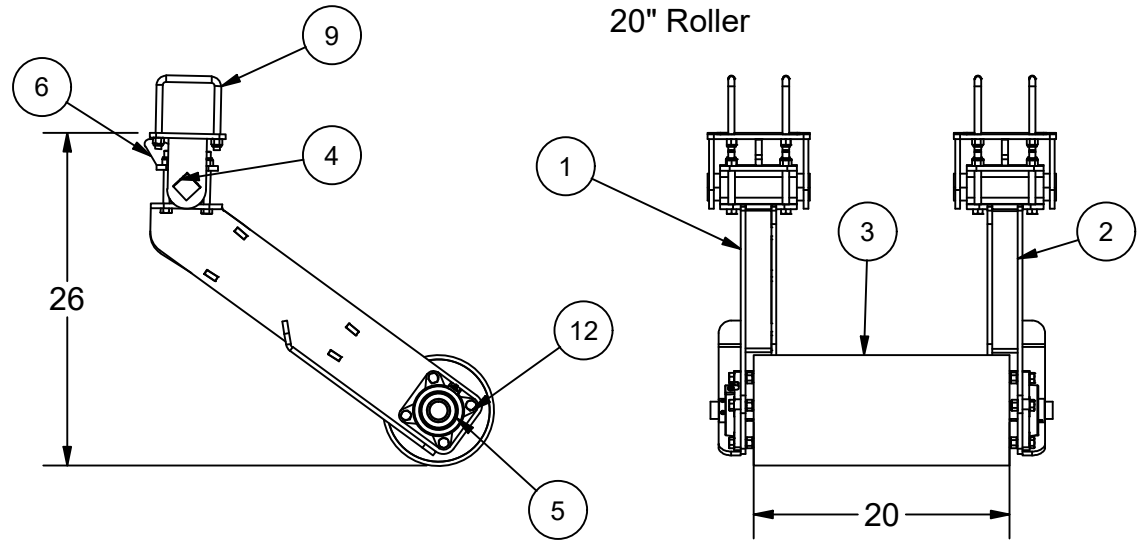

38" Roller

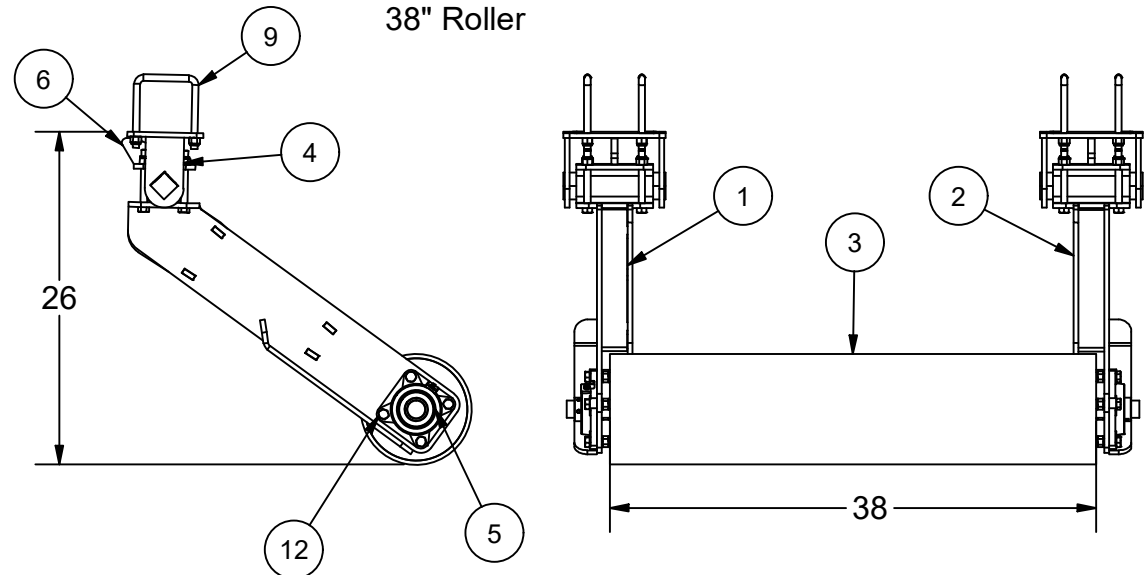

Parts List

ITEM	QTY	PART NUMBER	DESCRIPTION
1	1	SC-CP-A003	RH Arm Weldment
2	1	SC-CP-A005	LH Arm Weldment
3	1	SC-CP-A002	38 in Main Roller Weldment
4	2	SC-CP-A009	Torsion Shoe Rotater Weldment
5	2	BR1045	4 Bolt Flange Bearing
6	2	SC-CP-A004	Stopper Weldment
7	8	B1/2x4.5	Hex Bolt
8	24	N1/2NYL	1/2 Std NC Nylock Nut
9	4	SCPPT1	1/2x4x5.25 SB U-Bolt
12	8	B1/2x1.5	Hex Bolt

**Patriot Equipment**  
1302 K Road Minden, NE  
308-832-0220

This drawing, and the information hereon, are the property of Minden Machine Shop Inc., and may be used only as authorized by us. Unpublished - All rights reserved under the copyright laws.

Stubble Crusher Roller Sizes

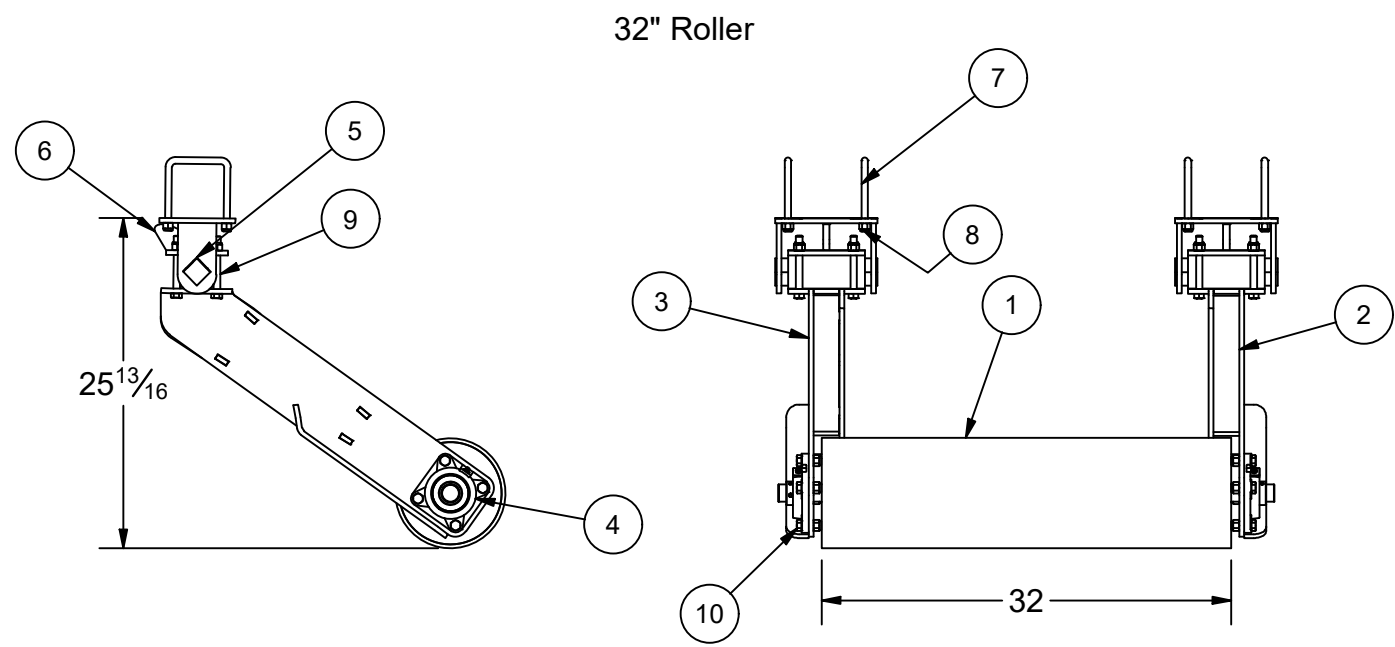

Parts List			
ITEM	QTY	PART NUMBER	DESCRIPTION
1	1	SC-CP-A025	32" Roller Assembly
2	1	SC-CP-A005	LH Arm Weldment
3	1	SC-CP-A003	RH Arm Weldment
4	2	BR1045	4 Bolt Flange Bearing
5	2	SC-CP-A009	Torsion Shoe Rotater Weldment
6	2	SC-CP-A004	Stopper Weldment
7	4	SCPPT1	1/2x5.25 SB U-Bolt
8	24	N1/2NYL	Nylock Nut
9	8	B1/2x4.5	Hex Bolt
10	8	B1/2x1.5	Hex Bolt

<b>Patriot Equipment</b> 1302 K Road Minden, NE 308-832-0220	This drawing, and the information hereon, are the property of Minden Machine Shop Inc., and may be used only as authorized by us. Unpublished - All rights reserved under the copyright laws.
--	---

Stubble Crusher  
Hydraulics

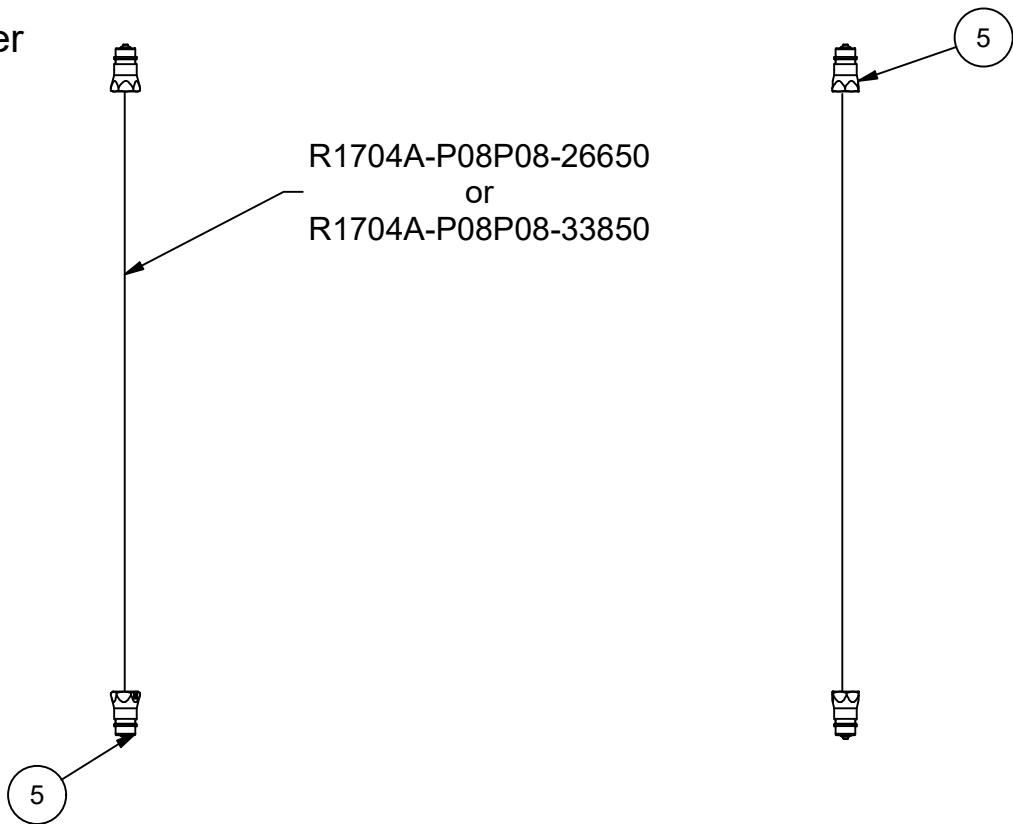

Parts List			
ITEM	QTY	PART NUMBER	DESCRIPTION
1	2	HCY1004	2.5 x 8 Hydraulic Cylinder
2	4	6801-6-6	90 Degree Fitting
3	2	6803-6-6-8	Tee Fitting
4	2	2285991	Quick Coupler
5	4	2286034	Hydraulic Tip

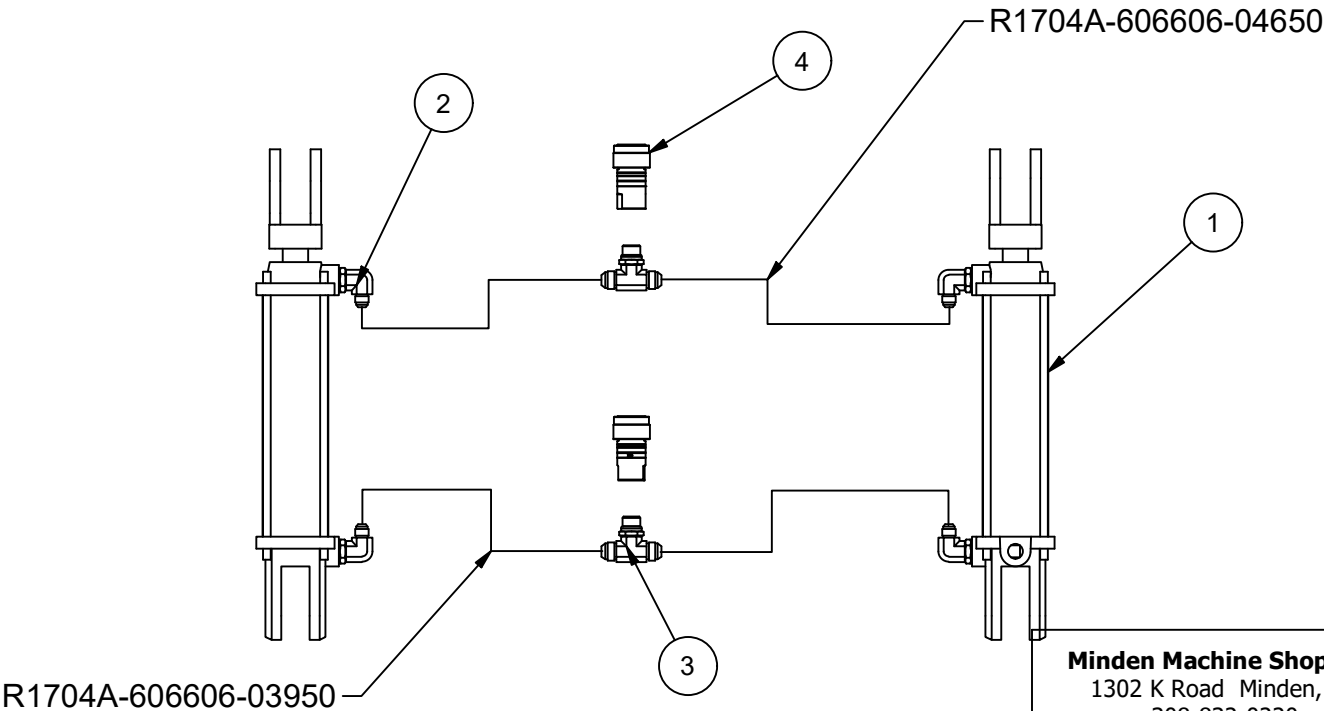

## Setup

Refer to the installation manual for complete setup. The Stubble Crusher hydraulics can be used from a SCV port on the tractor or they can be installed into the three point hydraulics. If installed with the three point hydraulics, the stubble crusher will raise and lower with the activation of the three point hitch. Please see the tractor dealer for instructions and fittings to correctly connect to the tractor three point hitch.

## Operation

**The Stubble Crusher must be in the raised position when the carrier vehicle is going to travel in a reverse direction. The Stubble Crusher can fold under itself if in the lower position and traveling in reverse which can cause damage to the Stubble Crusher.**

The Stubble Crusher is designed to operate while the attachment vehicle is traveling in a forward motion. The Stubble Crusher shoes or rollers are lowered with the hydraulic cylinder to engage the stalk or stem of the crop residue. The Stubble Crusher will push the residue stalk or stem over increasing the surface area of the stalk or stem that the tire will engage. The increased surface area engagement decreases the amount of sharp residue contact with the tires, which will decrease tire wear and increase tire life.

The operation of the Stubble Crusher is automated if the Stubble Crusher hydraulic lines are connected to the three point hitch hydraulic system. The Stubble Crusher hydraulic cylinders will raise and lower with the activation of the three point hitch system. Cylinder stops will have to be used to limit the raise height if needed.

Using the SCV port of the tractor to raise and lower the Stubble Crusher can be done as well. Connect the Stubble Crusher hydraulic hoses into the selected SCV port. Connect the hoses so that the Stubble Crusher will lower with the activation of the SCV lever/switch in the forward position and the Stubble Crusher will rise with the activation of the SCV lever/switch in the opposite direction. Installation of the hydraulic hoses in this manner will allow the operator to go into the "float" position if desired for operation of the Stubble Crusher in the lowered position. If the tractor is equipped, adjust the flow of the hydraulic SCV port so the cylinders raise and lower at a reasonable speed. If the cylinders raise and lower too fast, damage could occur to the Stubble Crusher frame or to the hydraulic cylinder itself. Also, if the tractor is equipped, adjust the timer of the SCV port. The timer will allow the hydraulics to activate for that amount of time so the operator can use that to extend or retract the hydraulic cylinder to its desired distance.

## Troubleshooting

<u>Symptom</u>	<u>Check and/or Adjust</u>
Stubble Crusher will not raise or lower	<ul style="list-style-type: none"><li>• Are hydraulic lines connected to the tractor</li><li>• Is SCV port timer set to zero or off</li><li>• Is Stubble Crusher frame bent</li><li>• Is the correct SCV lever/switch being used</li><li>• Check hydraulic fluid level of attachment vehicle.</li></ul>
Stubble Crusher is too aggressive	<ul style="list-style-type: none"><li>• Raise the Stubble Crusher with hydraulic cylinder</li><li>• Raise the height of the Stubble Crusher at mount</li></ul>
Stubble Crusher not aggressive	<ul style="list-style-type: none"><li>• Lower the Stubble Crusher with hydraulic cylinder</li><li>• Lower the height of Stubble Crusher at mount</li></ul>

## Service/Maintenance

- Inspect the Stubble Crusher periodically checking for wear on the shoes and replace as needed.
- Stubble Crusher models with the drums should be greased every 50 hours of use.
- Inspect drums and if worn, replace.
- Inspect and replace drum bearings if needed.
- Inspect the frame annually for any cracks or excessive wear



- **Danger!** Never use any part of the human body to inspect for hydraulic leaks! Serious Injuries or Death could result! Use a piece of cardboard if necessary to find leaks.
- Inspect the hydraulic system. Repair any leaks that are found and repair or replace leaking hydraulic cylinders.
- Inspect fasteners. Tighten any that are loose. If any fasteners are missing or broken, replace.

## Storage

The Stubble Crusher can be removed from the attachment vehicle if desired. Store the Stubble Crusher in an area that is away from children so that it can't be played on. The optional storage stands for the Stubble Crusher can be purchased if desired.

Optional Equipment

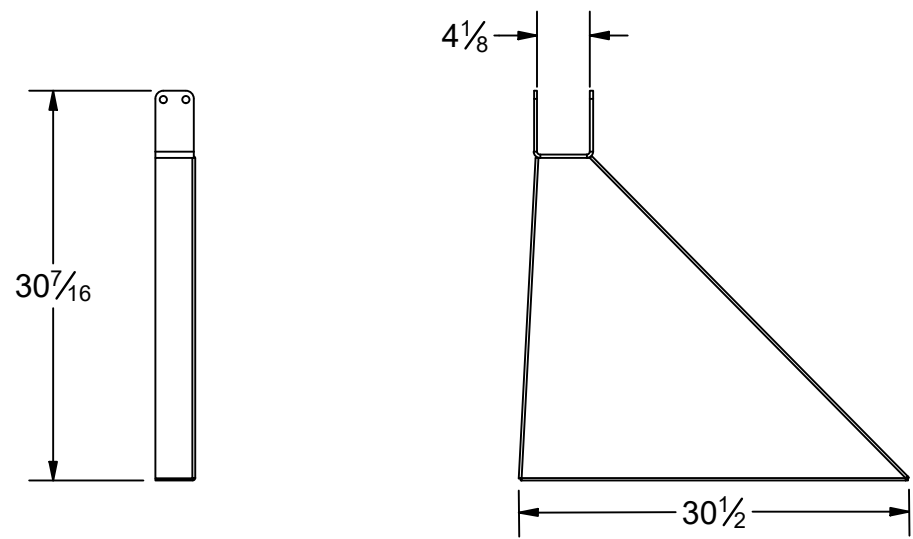

Parking Stands  
P/N: SC-CP-A024



**Patriot Equipment**  
1302 K Road Minden, NE  
308-832-0220

This drawing, and the information hereon, are the property of Minden Machine Shop Inc., and may be used only as authorized by us. Unpublished - All rights reserved under the copyright laws.

## California Proposition 65

The Safe Drinking Water and Toxic Enforcement Act of 1986 (California Proposition 65, commonly known as Prop 65) applies to companies doing business in the State of California. The regulation is administered by the Office of Environmental Health Hazard Assessment (OEHHA) and mandates that no person in the course of doing business shall knowingly expose any individual to a chemical known to the State of California to cause cancer and/or reproductive toxicity without first giving clear and reasonable warning to individuals. If the business can prove that the exposure level poses no significant risk to the end consumer no warning is necessary.

Minden Machine Shop, Inc. is providing the information below to educate about the chemicals that are or could be found in the products that Minden Machine Shop, Inc. produces or uses in their products.

Material	Chemical	CAS #	Cancer, Reproductive Harm or Both?
Cast Iron	Nickel	7440-02-0	Cancer
	Arsenic	7440-38-2	Both
	Cobalt	7440-48-4	Cancer
	Lead	7439-92-1	Both
Steel	Nickel	7440-02-0	Cancer
Stainless Steel	Nickel	7440-02-0	Cancer
Paint Finishes	Carbon Black	1333-86-4	Cancer
	Toluene	108-88-3	Reproductive Harm
	Lead	7439-92-1	Both
Rubber Compounds	Acrylonitrile	107-13-1	Cancer
	Butadiene	106-99-0	Both
	DEHP	117-81-7	Both
EPDM	Carbon Black	1333-86-4	Cancer
Petroleum	Cadmium	-----	Both
Petroleum	Isoprene	78-79-5	Cancer

Additional information on Proposition 65 can be obtained by visiting the State of California's Proposition 65 website:

<https://oehha.ca.gov/proposition-65/about-proposition-65>

Summary of Proposition 65 requirements:

<https://oehha.ca.gov/proposition-65/general-info/proposition-65-plain-language>

Clear and reasonable notice requirements:

<https://oehha.ca.gov/proposition-65/cnr/notice-adoption-article-6-clear-and-reasonable-warnings>

Chemicals and substances regulated by Proposition 65:

<https://oehha.ca.gov/proposition-65/proposition-65-list>

Proposition 65 Laws and Regulations:

<https://oehha.ca.gov/proposition-65/law/proposition-65-law-and-regulations>

Minden Machine Shop, Inc. has placed this decal on our products to alert the user to the possible exposures.

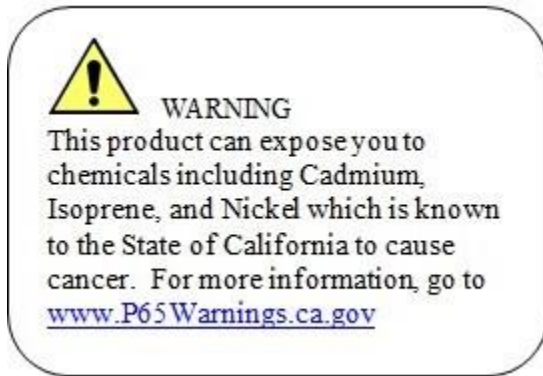



# Minden Machine Shop Inc

## LIMITED WARRANTY

Minden Machine Shop Inc warrants all products manufactured by it to be free of defect in material and workmanship for a period of one (1) year from the date of purchase.

This Minden Machine Shop Inc. warranty does not cover:

1. Parts and accessories supplied by Minden Machine Shop Inc. but manufactured by others. Minden Machine Shop Inc. will facilitate the other manufacturer warranty for the benefit of the purchaser but will not be bound thereby (example: augers, motors, trailers, tanks, etc.).
2. Products that have been altered by anyone other than a Minden Machine Shop Inc. employee or are used by the purchaser, for purposes other than what was intended at time of manufacture or used in excess of the "built specifications".
3. Products that are custom manufactured by Minden Machine Shop Inc. utilizing the purchaser's design which deviates from Minden Machine Shop Inc. normal production line manufactured or customized features of the products.
4. Malfunctions or damages to the product from misuse, negligence, customer alteration, accidents or product abuse due to incoming material or poor material flow ability or lack of required performance or required maintenance (e.g., poor material flow ability caused by incoming wet fertilizer or hot soybean meal, etc).
5. Loss of time, inconvenience, loss of material, down time or any other consequential damage.
6. Product use for a function that is different than designed intent (e.g., storing soybean meal in grain bin, unacceptable material in the bin such as hot bean meal when product originally designed for other application, etc).
7. Minden Machine Shop Inc is not responsible for any equipment that this product is attached to or mounted on.

To activate this warranty, the purchaser must make contact in writing with Minden Machine Shop Inc. within one (1) year of date of purchase. After contact, Minden Machine Shop Inc. has the right to determine the cause and qualify the legitimacy of the claim. Minden Machine Shop Inc., upon acceptance of a warranty claim, shall have a reasonable time to plan any repair or replacement and may affect repair or replacement out of its factory or through contract with a local repair service. If a purchaser after warranty notice is made, chooses to make the repair itself, Minden Machine Shop Inc. must approve any expenses before they are incurred to be responsible for customer reimbursement. Minden Machine Shop Inc. shall be liable on a warranty claim for repair or replacement of any defective products and this is the purchaser's sole and exclusive remedy. Minden Machine Shop Inc. will not be liable for any other or further remedy including claims for personal injury, property damage or consequential damage. The law of the State of Nebraska shall govern and any such claim and any issues with regard to the same shall be resolved in the Nebraska District Court for the county of Kearney.

## RETURN OF MERCHANDISE

Merchandise may not be returned without written approval from the factory. All returns must have a return authorization number. Obtain this number before the return and show it on all return items. A 15% restocking charge is made on merchandise returned. Returned merchandise must be shipped pre-paid.

## RECEIVING MERCHANDISE AND FILING CLAIMS

When receiving merchandise it is important to check both the number of parts and their description with packing slip. The consignee must make all claims for freight damage or shortage within 10 days from the date of delivery.

When the material leaves the factory it becomes the property of the consignee. It is the responsibility of the consignee to file a claim on any possible damage or loss. Please list your preferred routing on purchase orders.

## MODIFICATIONS

It is the policy of Minden Machine Shop Inc. to improve its products whenever possible and practical to do so. We reserve the right to make changes, improvements and modifications at any time without incurring the obligation to make such changes, improvements and modifications on any equipment sold previously.

# WARRANTY REGISTRATION

To register equipment, or file a claim, copy and paste the words on this page into an email or word document, fill out the appropriate information completely, and email it to [larry@mindenmachine.com](mailto:larry@mindenmachine.com) with the subject as EQUIPMENT WARRANTY, or fill it out and fax it to 308-832-1340.

**Dealer Information:** Not Applicable, check here: [   ]

Dealer Name:

Address:

City:

State:

Zip Code:

Phone #:

Email:

**End User Information:**

Purchaser:

Address:

City:

State:

Zip Code:

Phone #:

Email:

Equipment:

Serial #:

Date Of Purchase:     /     /

# Installation Guide



## **Stubble Crusher Installation Instruction Guide (Recommended two (or more) man job)**

- Step 1: Remove weight bracket if there is one.
- Step 2: Attach stubble crusher undercarriage bracket.
- Step 3: Re-attach weight bracket as shown below.



Step 4: Attach both the left and right side Height Adjustment Bar (Item 4 ) using provided u-bolts and nuts. Begin with bottom of the Height Adjustment Bar at 21" from ground.

Once the bars are set, you may want to re-adujst them later to fit, so leave them loose enough to make it easier to adjust, yet tight enough to hold.



Step 5: Connect upper linkage bars (14) together using 3/4" x 4" Bolt Spacer Tube (11).



Step 6: Bolt linkage bars to height adjustment bars and attach Lower Linkage Arm (13) to Height Adjustment Bar (4).



Step 7: Place Tool Bar (15) in front of tractor. Measure to find and mark the center. Measure distance between each height adjustment bar and note. Align square tube center with middle distance between height adjustment bars.





Step 8: Loosely attach lower linkage bars (7) to Tool Bar using u-bolts.



Note: Depending on the make and model of your tractor, and the configuration of your weights, the hydraulic hoses will need to be attached from the inside or outside direction from the undercarriage bracket to the hydraulic cylinder. You may also need to modify your hoses with elbow joints in order to best attach your hydraulic hoses to the hydraulic cylinders.



Step 9: Attach hydraulic cylinder with 1" x 5 1/2" bolts to lower linkage arm (13).





Step 11: Align lower linkage bar (7) with bottom bolt hole of lower linkage arm (13) and attach.



Step 12: Attach torsion springs (17) to tool bar (15), making sure they are aligned with the tractor tires.



Step 13: Place two bolts in front bolt holes on torsion shoe attachment plates (18).

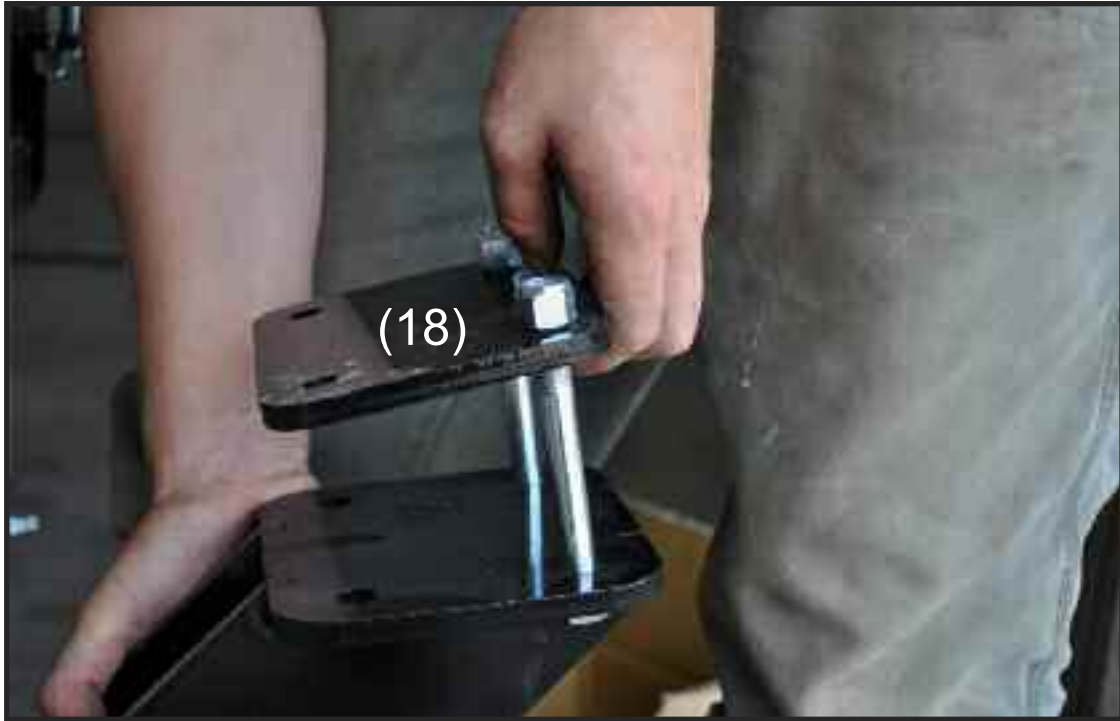

Attach torsion shoes to torsion springs as shown below.





Step 14: Bolt two rear bolts to torsion shoe attachment plates as shown below.



Note: The height of your tool bar (15) may vary depending on the height of your tractor's front end. (Bar height examples below).



Note: Stubble Crusher shoes do NOT need to reach all the way to the ground in order to knock over corn stalks or stubble. Increased wear on shoes may occur if shoes are set too low.

