

PATRIOT™

Gama Electronics And Patriot Equipment

Owner's Manual



Minden Machine Shop Inc.
1302 K Road
Minden, NE 68959
308-832-0220

TABLE OF CONTENTS

Gama Electronics	3
Programming Gama Electronics	6
Changing the Key Fob Battery	7
Programming Multiple Key Fobs	8
Wire Harnesses	9

Gama Electronics

The Gama Electronics wireless control is designed to provide quality wireless performance. The unit is essentially maintenance free with the exception being a battery replacement for the key fob. All of the components are designed to provide a reliable and durable wireless system.

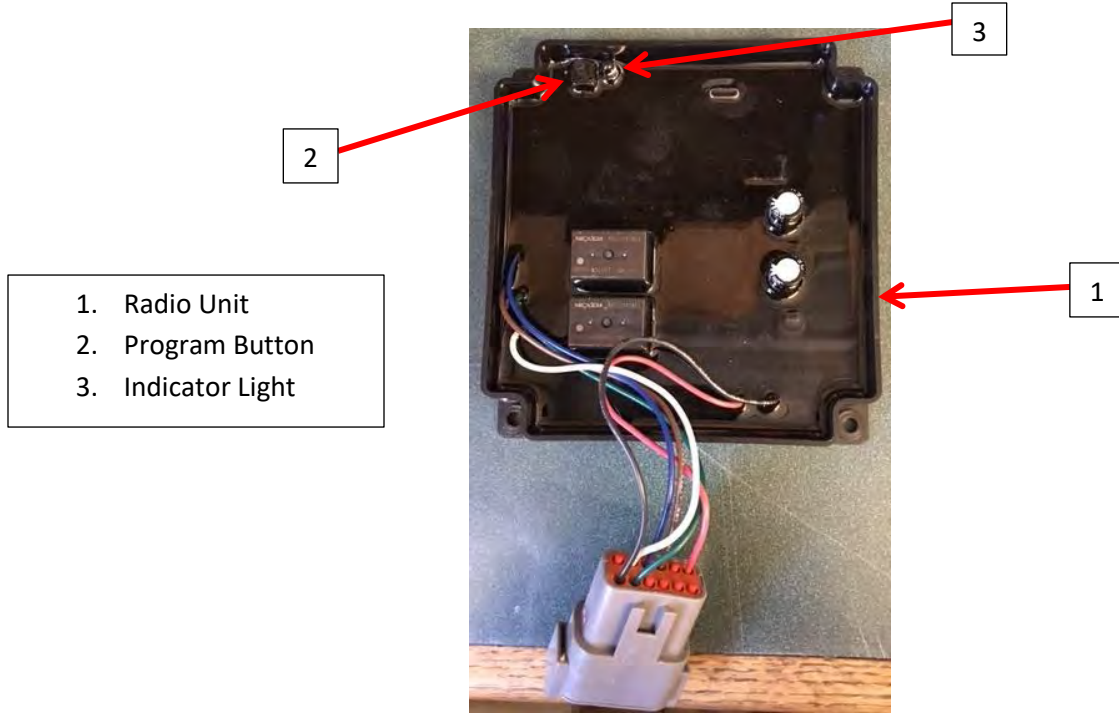

Safety Precautions



DANGER!

Never leave the transmitter (key fob) left unsupervised when the receiver is powered on. The transmitter can be activated which could lead to an accident with severe injuries or death.



CAUTION!

If this product is used in a way other than intended, this can result in product malfunctions which can lead to injuries or death.

Any misuse or evidence of tampering will void the warranty.

Power

The Gama Electronics wireless controller may be used to directly control power to applications. An adequate power supply is necessary for correct performance. The radio unit will draw a small amount of power over time when it is in standby mode which can discharge the battery. Disconnect the radio unit when charging the battery or doing any electrical work.

Programming

Please see the "Programming GAMA Electronics"

Mounting

The radio unit should be mounted with the electrical plug pointing down in an area that will protect the radio unit as much as possible. Correct mounting will ensure correct performance as well as a long service life.

Wiring

The wire harness is specific to the radio unit. The wiring harness has a 7.5 amp fuse installed in it. Do Not use a higher amp rated fuse as this can damage the radio unit. Inspect the wire harness regularly for any damage.

Operation

Once the radio unit is powered up, it is ready for operation. The unit has an effective range; however, the range can be decreased depending upon battery condition, receiver mounting location, and numerous obstructions.

Battery Replacement

See "Battery Change Instructions."

Troubleshooting

Most issues will originate with power supply issues.

1. Replace the key fob battery
2. Check the main power for the radio
3. Inspect the power and ground wire connections
4. Check the fuse in the power wire

If you are unable to resolve any issue, feel free to contact Patriot Equipment at 308-832-0220.

Key Fob (Transmitter)



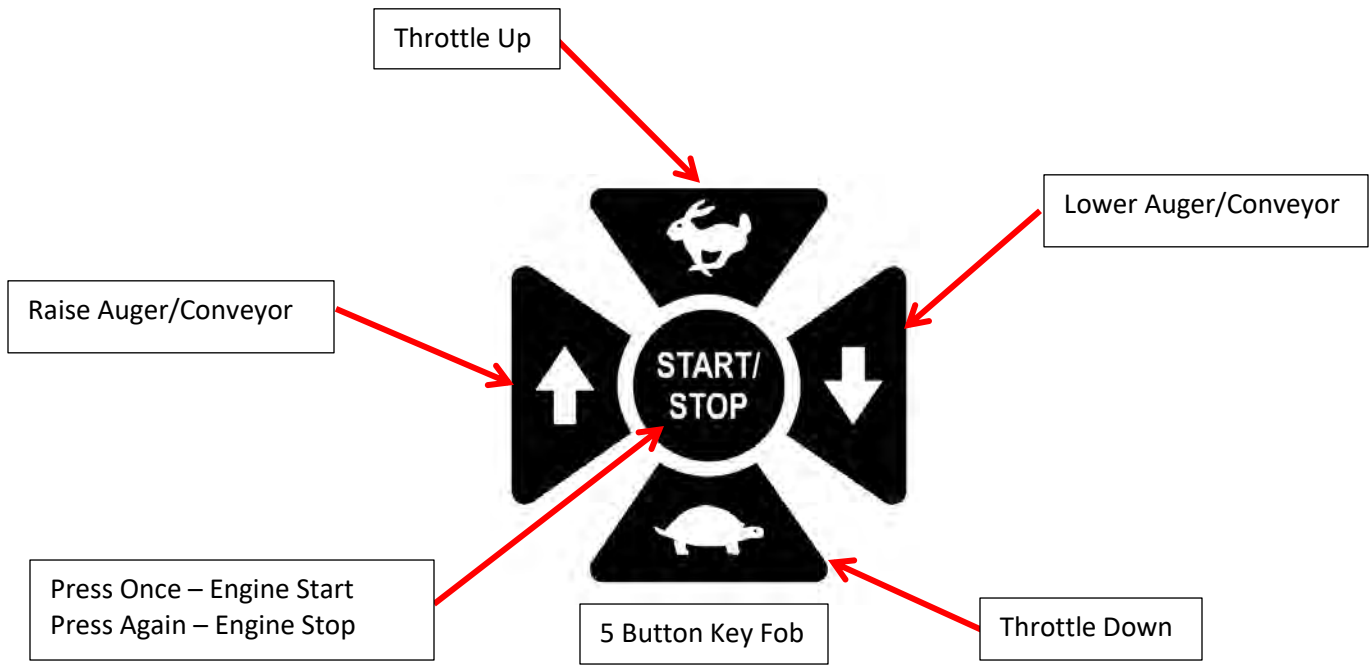

Programming GAMA Electronics

Press and hold the black button on the control unit until the red light comes on.

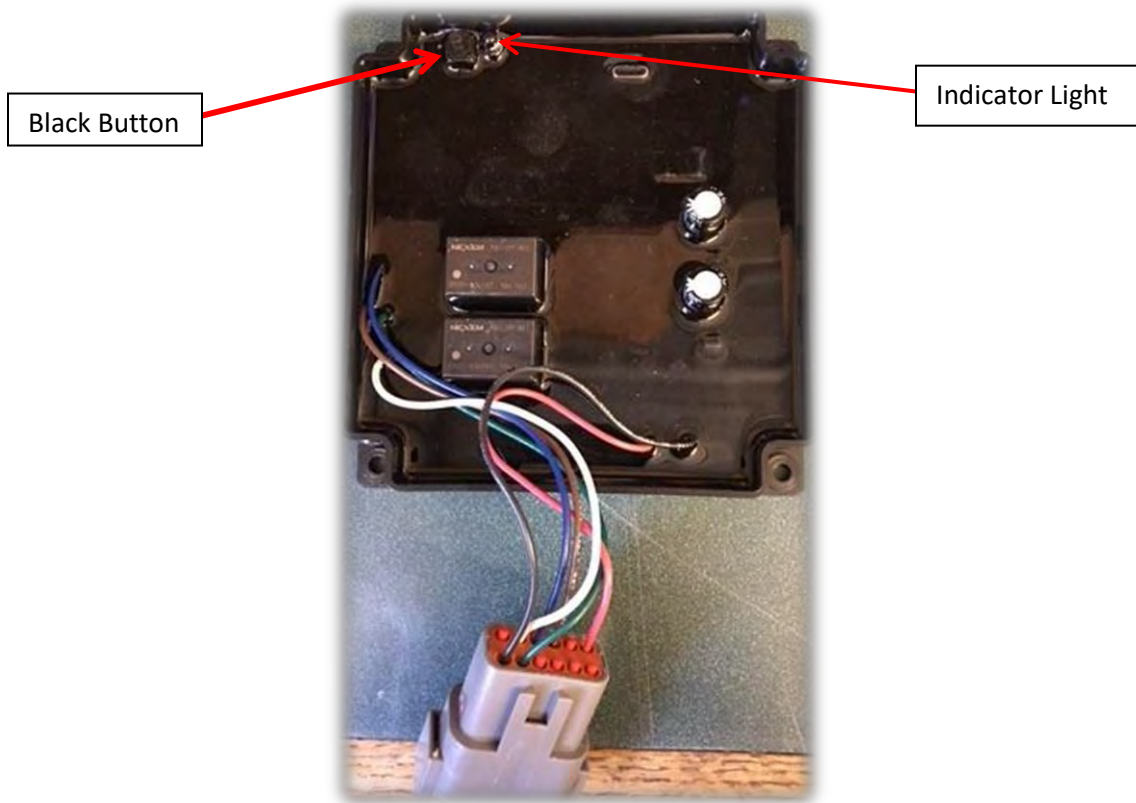

Press any key on the key fob and hold it until the red light blinks once. (Four button model shown)



The key fob is now programmed to the control unit.

GAMA Key Fob Battery Change

Turn the key fob over so that the housing retaining screws are visible. Using a phillips screw driver, remove the screws.

Screw locations that hold the key fob together.

Use a phillips screw driver to remove the screws and set aside



Once the screws have been removed, set them aside. Separate the key fob halves. Inspect the key fob for any internal damage or missing parts. The key fob should look like the below picture.



Remove the old A23 battery and discard in a safe manner. Insert a new A23 battery in the correct manner.

Reassemble the key fob. If the key fob doesn't work, the battery may be installed backwards.



Part Number S4591

Patriot Seed Tender Transmitter Pairing Instructions.

The S4591 control is designed to work with 4 button or 5 button key fobs.

- The 5-button key fob has conveyor control buttons.

The S4591 control needs to be programmed to recognize which key fob is to be used.

This is done during the pairing procedure as follows:

1. Open the lid of the control and locate the pairing button which has an LED next to it.
 - Programming the remotes must be done quickly after pairing button is pressed and the programming period has begun, if LED blinks rapidly and shuts off you will need to start over as the programming time period has ended.
2. Press and hold the pairing button until the LED turns on (around 3 seconds).
3. Release pairing button.
 - At this point, any previously programmed key fobs will be erased from memory.
4. Press and release the appropriate key fob button:
 - a. If using the 5-button key fob, press and release the center START/STOP button.
 - b. If using the 4-button key fob, press and release the START button.
5. The LED will blink off then back on one time.
6. When pairing multiple key fobs press the button on the next key fob. This must be done within 3 seconds of pairing the previous key fob.
7. The LED will blink off then back on one time each time an additional fob is paired.
8. Repeat for additional key fobs.

NOTE: The LAST key fob paired determines the type of key fob used. (see step 5).
9. After the last key fob is paired, wait 5 seconds. The LED will blink rapidly and turn off.

The control is now ready to use.

S4593
BASIC GAMMA HARNESS
W/ CONVEYOR WIRES
USE WITH UNIVERSAL RADIO

Start/Stop Engine
 Wires
 Bullet Connectors

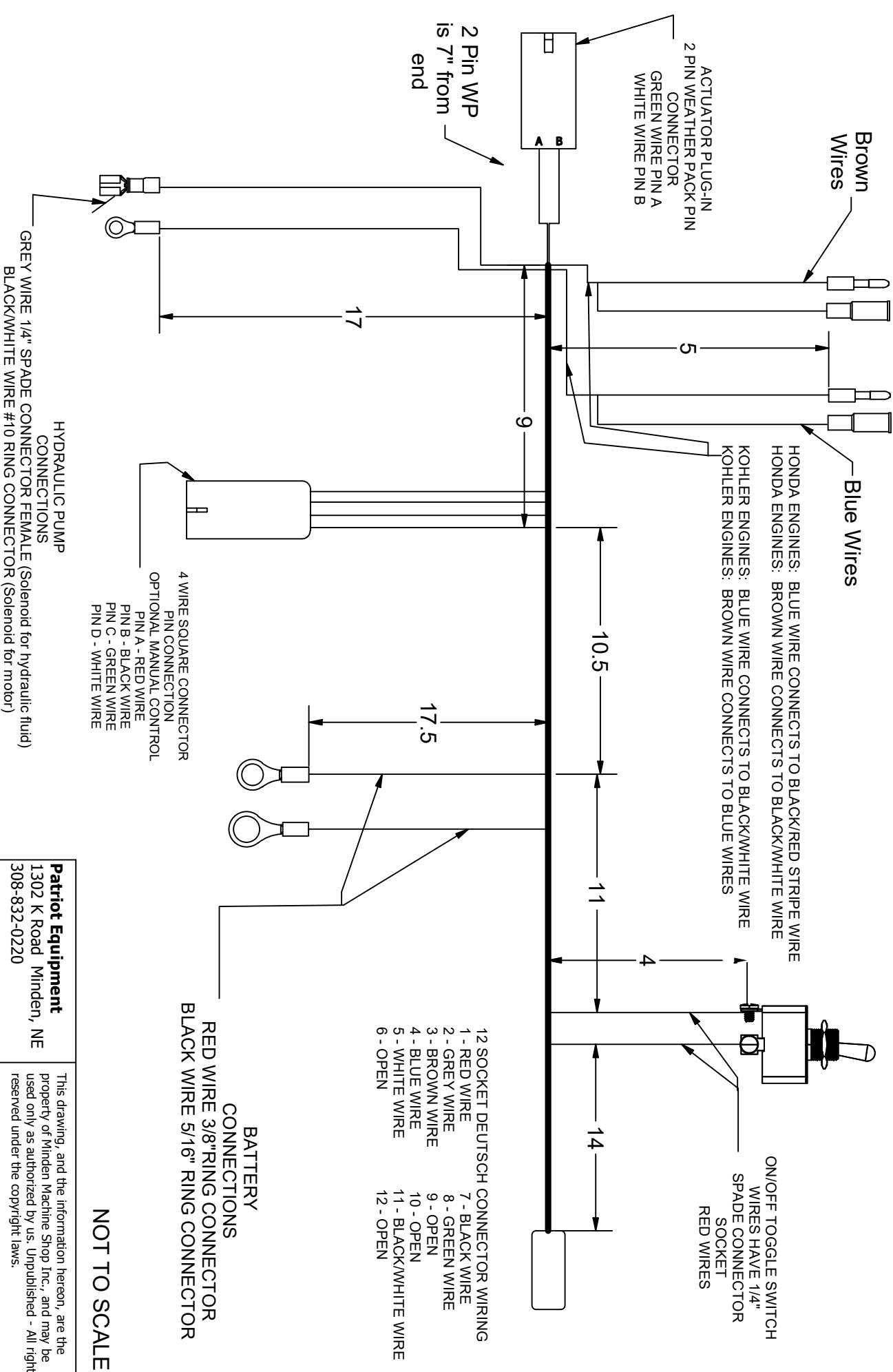

HYDRAULIC PUMP
 CONNECTIONS

4 WIRE SQUARE CONNECTOR
 PIN CONNECTION
 OPTIONAL MANUAL CONTROL
 PIN A - RED WIRE
 PIN B - BLACK WIRE
 PIN C - GREEN WIRE
 PIN D - WHITE WIRE

GREY WIRE 1/4" SPADE CONNECTOR FEMALE (Solenoid for hydraulic fluid)
 BLACK/WHITE WIRE #10 RING CONNECTOR (Solenoid for motor)

- 12 SOCKET DEUTSCH CONNECTOR WIRING
- 1 - RED WIRE
 - 2 - GREY WIRE
 - 3 - BROWN WIRE
 - 4 - BLUE WIRE
 - 5 - WHITE WIRE
 - 6 - OPEN
 - 7 - BLACK WIRE
 - 8 - GREEN WIRE
 - 9 - OPEN
 - 10 - OPEN
 - 11 - BLACK/WHITE WIRE
 - 12 - OPEN

BATTERY
 CONNECTIONS
 RED WIRE 3/8" RING CONNECTOR
 BLACK WIRE 5/16" RING CONNECTOR

NOT TO SCALE

Patriot Equipment
 1302 K Road Minden, NE
 308-832-0220

This drawing, and the information hereon, are the property of Minden Machine Shop Inc., and may be used only as authorized by us. Unpublished - All rights reserved under the copyright laws.

HYDRAULIC PUMP
 CONNECTIONS
 GRAY WIRE 1/4" SPADE CONNECTOR FEMALE (Solenoid for hydraulic fluid)
 BLACK/WHITE STRIPE WIRE #10 RING CONNECTOR (Solenoid for motor)

S4594
Gama Harness, Scale and Conveyor

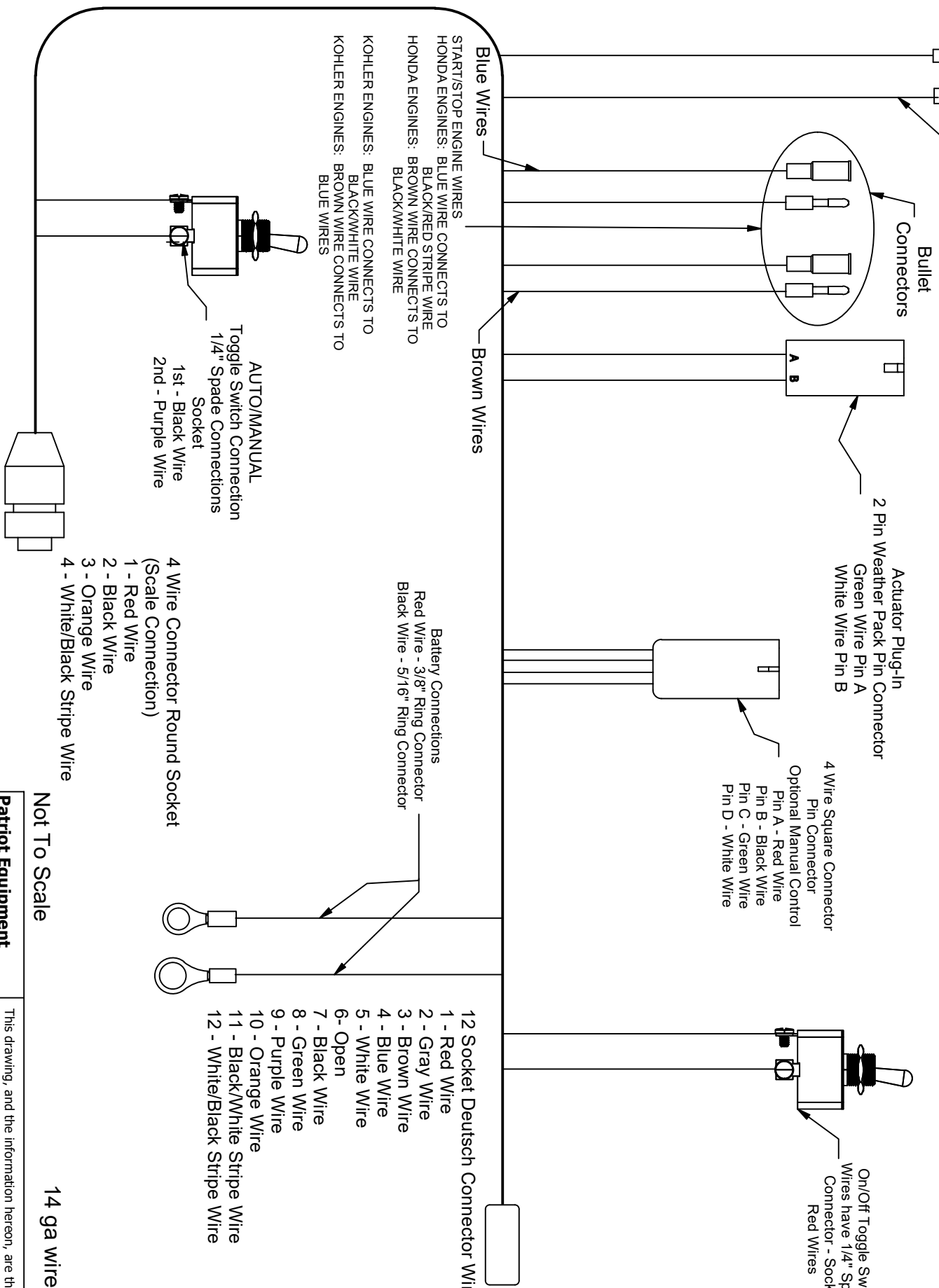

Blue Wires
 START/STOP ENGINE WIRES
 HONDA ENGINES: BLUE WIRE CONNECTS TO BLACK/RED STRIPE WIRE
 HONDA ENGINES: BROWN WIRE CONNECTS TO BLACK/WHITE WIRE
 KOHLER ENGINES: BLUE WIRE CONNECTS TO BLACK/WHITE WIRE
 KOHLER ENGINES: BROWN WIRE CONNECTS TO BLUE WIRES

Brown Wires
 Battery Connections
 Red Wire - 3/8" Ring Connector
 Black Wire - 5/16" Ring Connector

AUTO/MANUAL
 Toggle Switch Connection
 1/4" Spade Connections
 Socket
 1st - Black Wire
 2nd - Purple Wire

4 Wire Connector Round Socket (Scale Connection)
 1 - Red Wire
 2 - Black Wire
 3 - Orange Wire
 4 - White/Black Stripe Wire

- 12 Socket Deutsch Connector Wiring**
- 1 - Red Wire
 - 2 - Gray Wire
 - 3 - Brown Wire
 - 4 - Blue Wire
 - 5 - White Wire
 - 6 - Open
 - 7 - Black Wire
 - 8 - Green Wire
 - 9 - Purple Wire
 - 10 - Orange Wire
 - 11 - Black/White Stripe Wire
 - 12 - White/Black Stripe Wire

Not To Scale

14 ga wire

Patriot Equipment
 1302 K Road Minden, NE
 308-832-0220

This drawing, and the information hereon, are the property of Minden Machine Shop Inc., and may be used only as authorized by us. Unpublished - All rights reserved under the copyright laws.